

**Ground plan:**  
**Horizontal section at 6' high**  
 - solid line: extents below cut plane  
 - dashed line: extents above cut plane  
 - cutting plane indicated with black fill  
 - orange line refers to where the grasses are installed

*Witch*  
 by Jen Silverman

Directing: Tyler Christie  
 Lighting: Meredith Brown  
 Sound: Liz Atkinson  
 Costume: Andrew Burns  
 Tech Directing: TBA  
 Scenic: Inseung Park  
 Drafting: Inseung Park

The Winnepesaukee Playhouse

Ground Plan

Scale:

1/4" = 1'-0"

Date:

April 25, 2024



S.D. 13829  
 SCENIC DESIGNER

SIGNATURE *[Signature]*

# Witch

by Jen Silverman

Directing: Tyler Christie  
Lighting: Meredith Brown  
Sound: Liz Atkinson  
Costume: Andrew Burns  
Tech Directing: TBA  
Scenic: Inseung Park  
Drafting: Inseung Park

## The Winnepesaukee Playhouse

### Section

### Scale:

1/4" = 1'-0"

### Date:

April 25, 2024



S.D. 13829  
SCENIC DESIGNER

SIGNATURE 

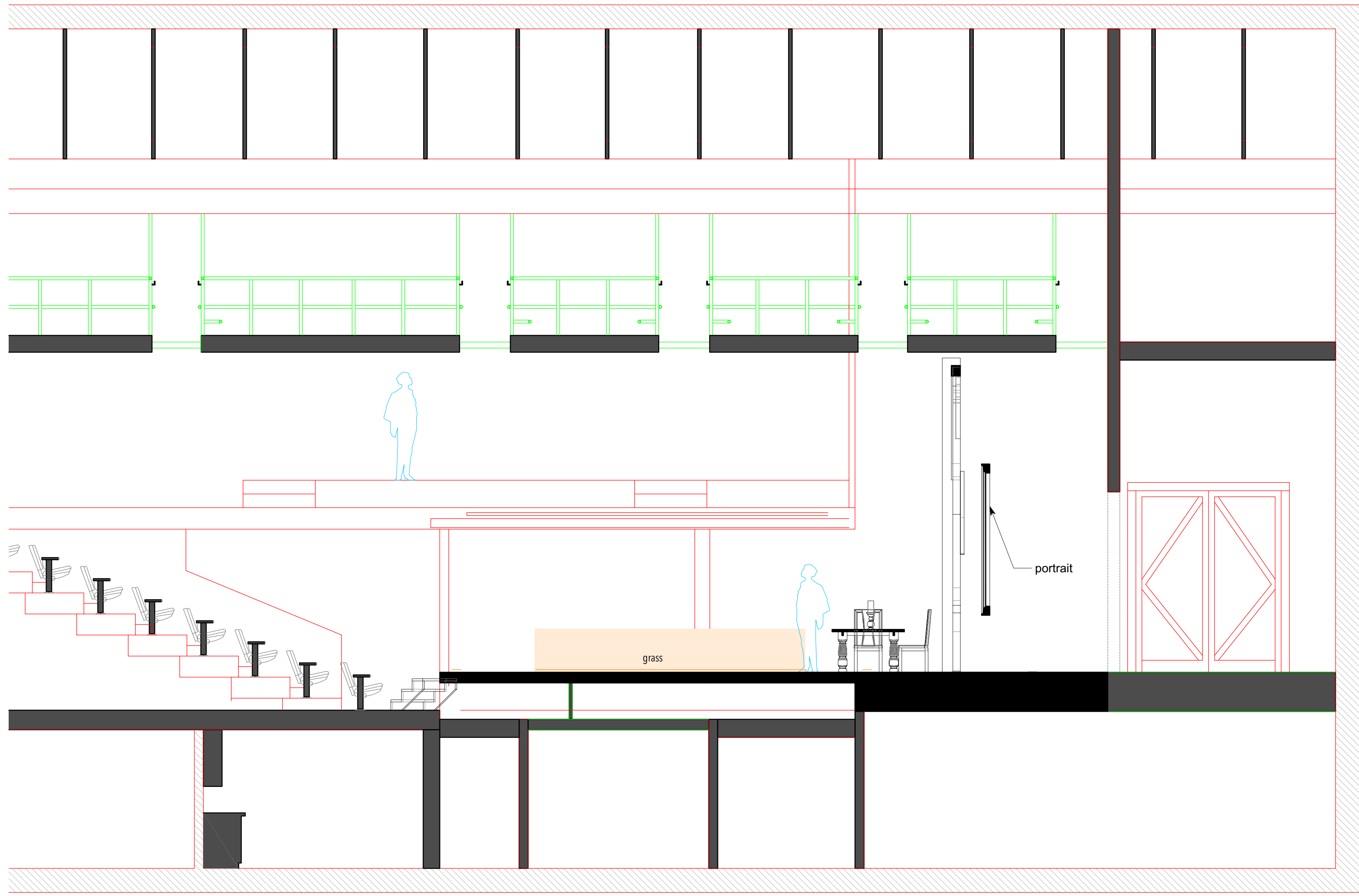

**A-1 Banquet table: front**

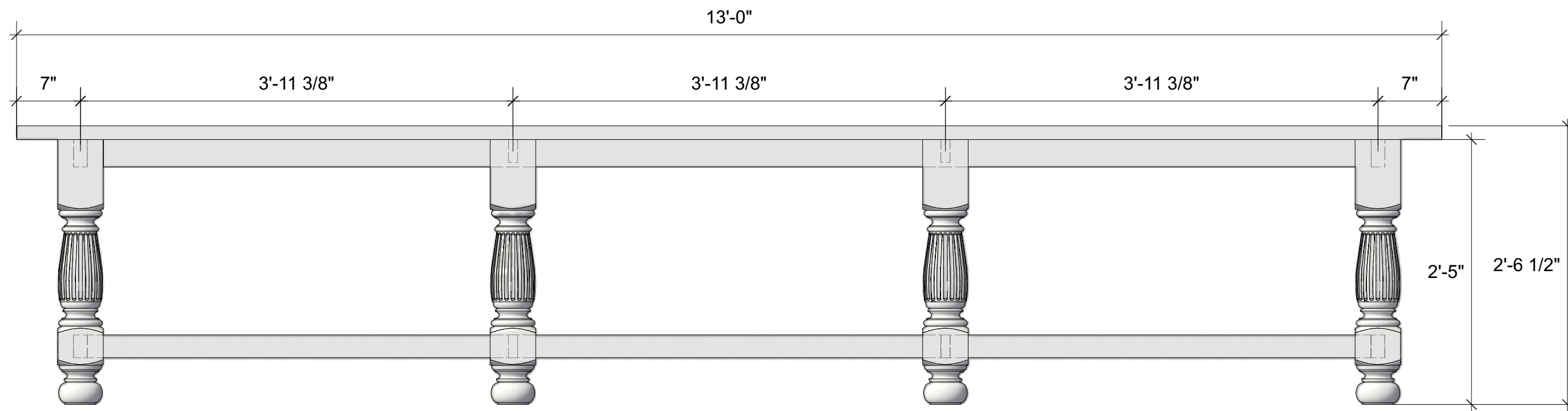

**NOTE:**

- The table legs are ordered: See figure 1. Design 59 monastery dining table legs, set of 8 turned posts, 29" tall, 5" square shank
- The table height is 2'-6" or 2'-6 1/2" depending upon the top material.
- Must be very sturdy: jumping and fighting scenes will happen on the table.

**A-2 Banquet table: plan**

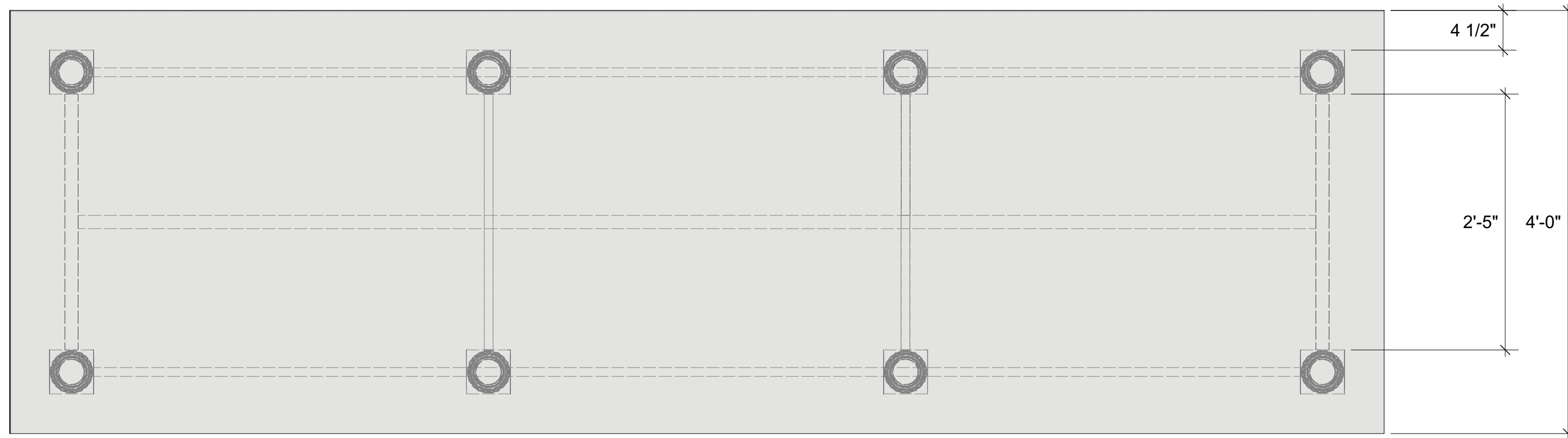

**A-3 Banquet table: perspective**

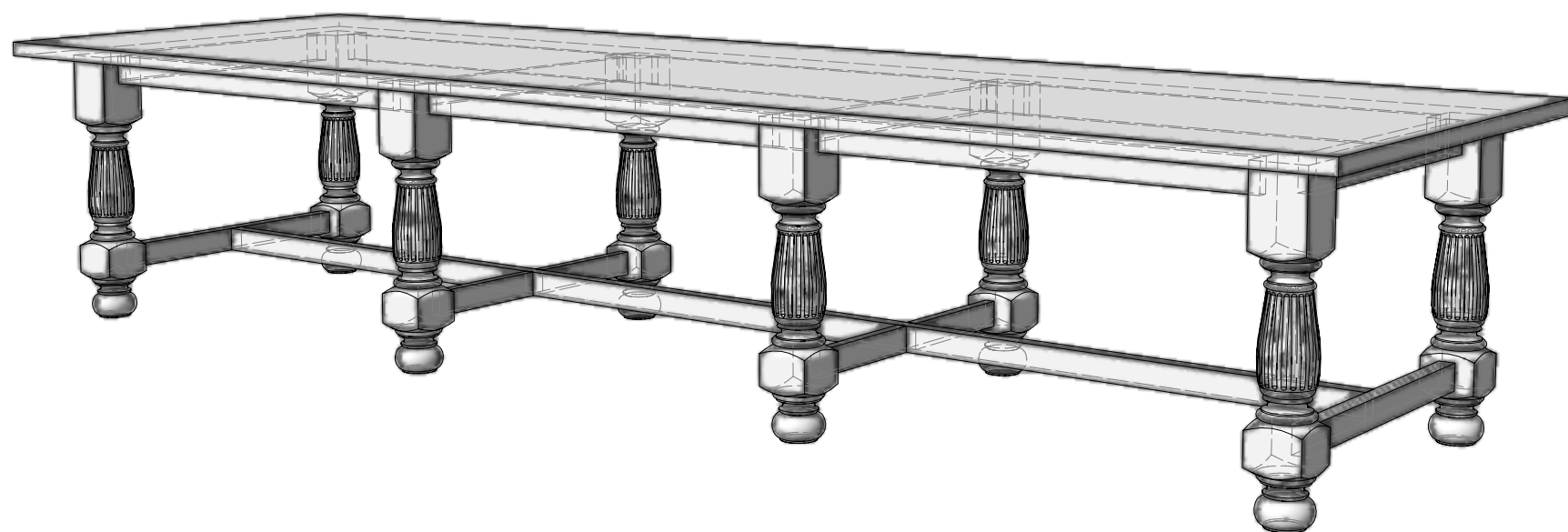

Figure 1.



*Witch*  
by Jen Silverman

Directing: Tyler Christie  
Lighting: Meredith Brown  
Sound: Liz Atkinson  
Costume: Andrew Burns  
Tech Directing: TBA  
Scenic: Inseung Park  
Drafting: Inseung Park

The Winnepesaukee Playhouse

Banquet Table

Scale:

1" = 1'-0"

Date:

April 25, 2024



S.D. 13829  
SCENIC DESIGNER

SIGNATURE *[Signature]*

**B-1 Castle arch: front**

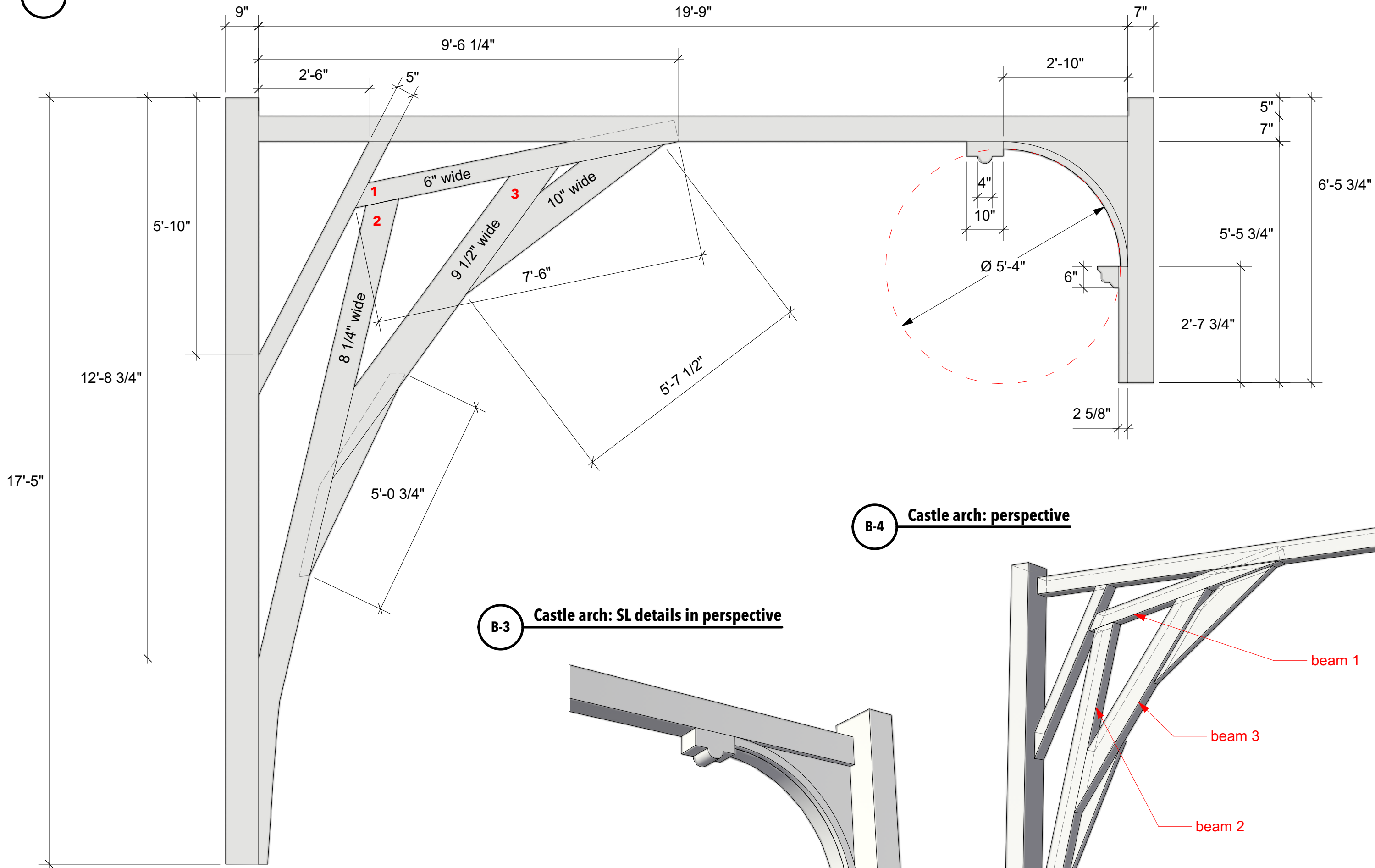

**B-4 Castle arch: perspective**

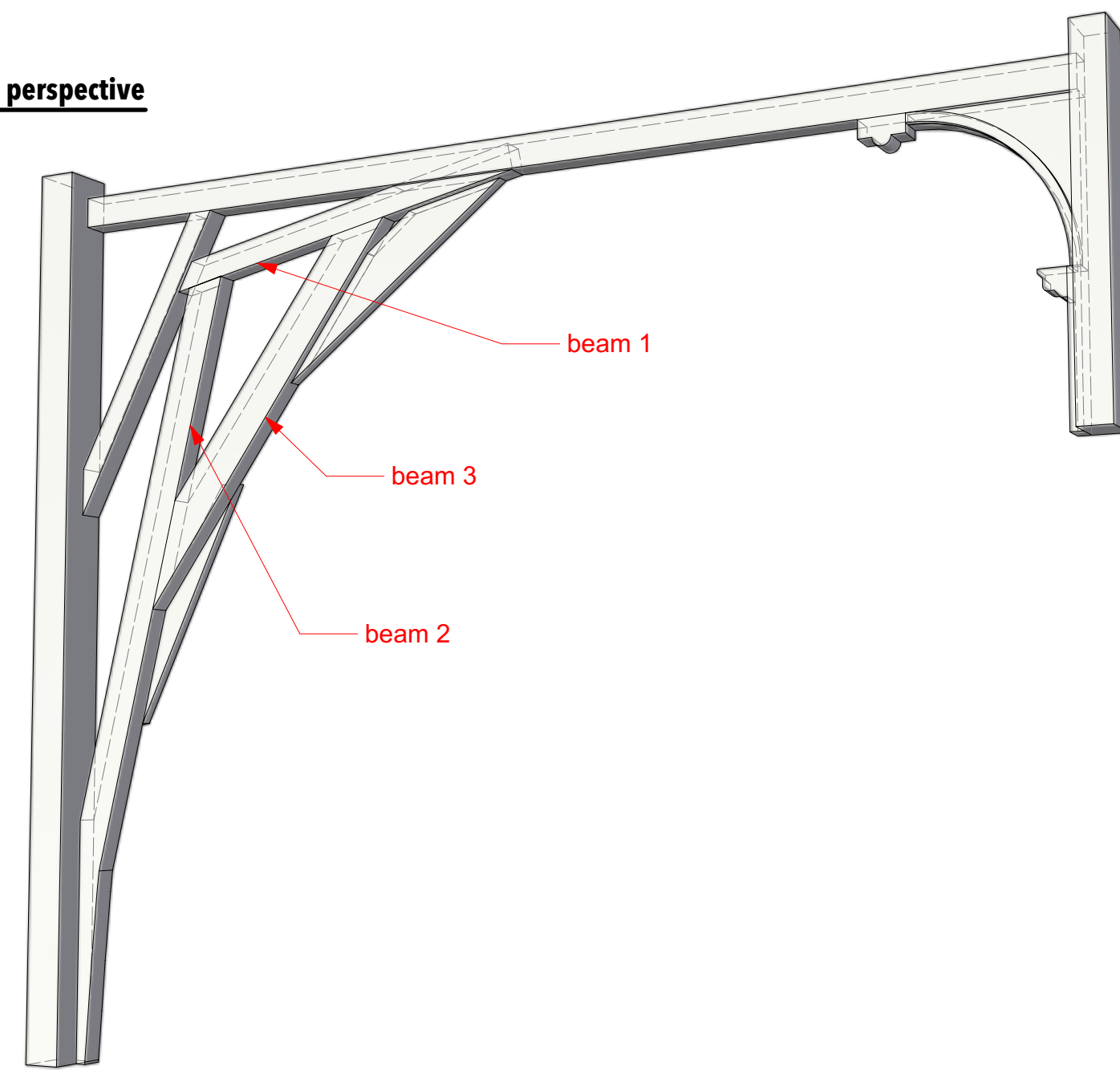

**B-3 Castle arch: SL details in perspective**

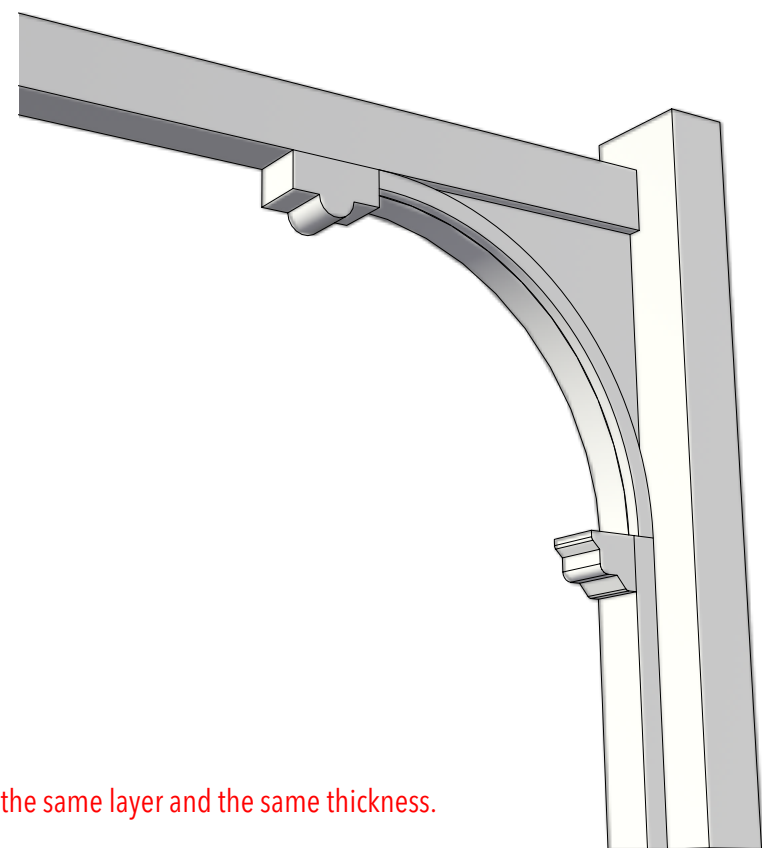

**NOTE:**

- See the viewport B-3 for SL portion details
- See the viewport B-4 to see the layers: beam 1, 2, 3 should be in the same layer and the same thickness.

**B-2 Castle arch: plan**

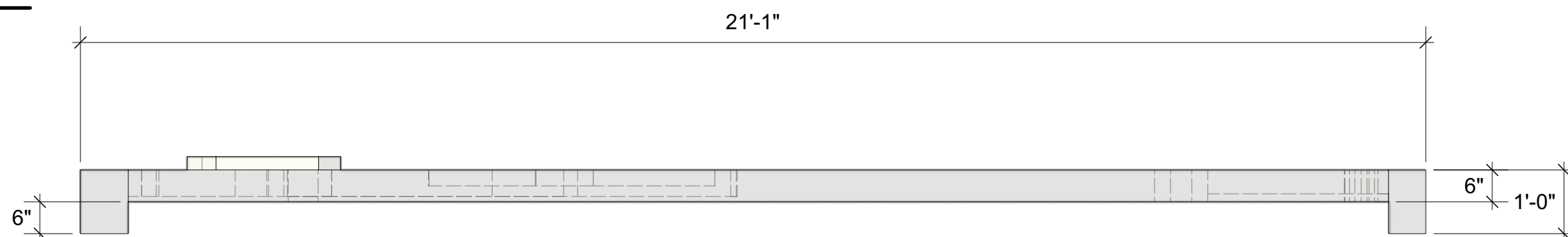

*Witch*

by Jen Silverman

Directing: Tyler Christie  
 Lighting: Meredith Brown  
 Sound: Liz Atkinson  
 Costume: Andrew Burns  
 Tech Directing: TBA  
 Scenic: Inseung Park  
 Drafting: Inseung Park

The Winnepesaukee Playhouse

Castle arch

Scale:

1/2" = 1'-0"

Date:

April 25, 2024



S.D. 13829  
 SCENIC DESIGNER

SIGNATURE *[Signature]*

**C-1 Portrait: front**

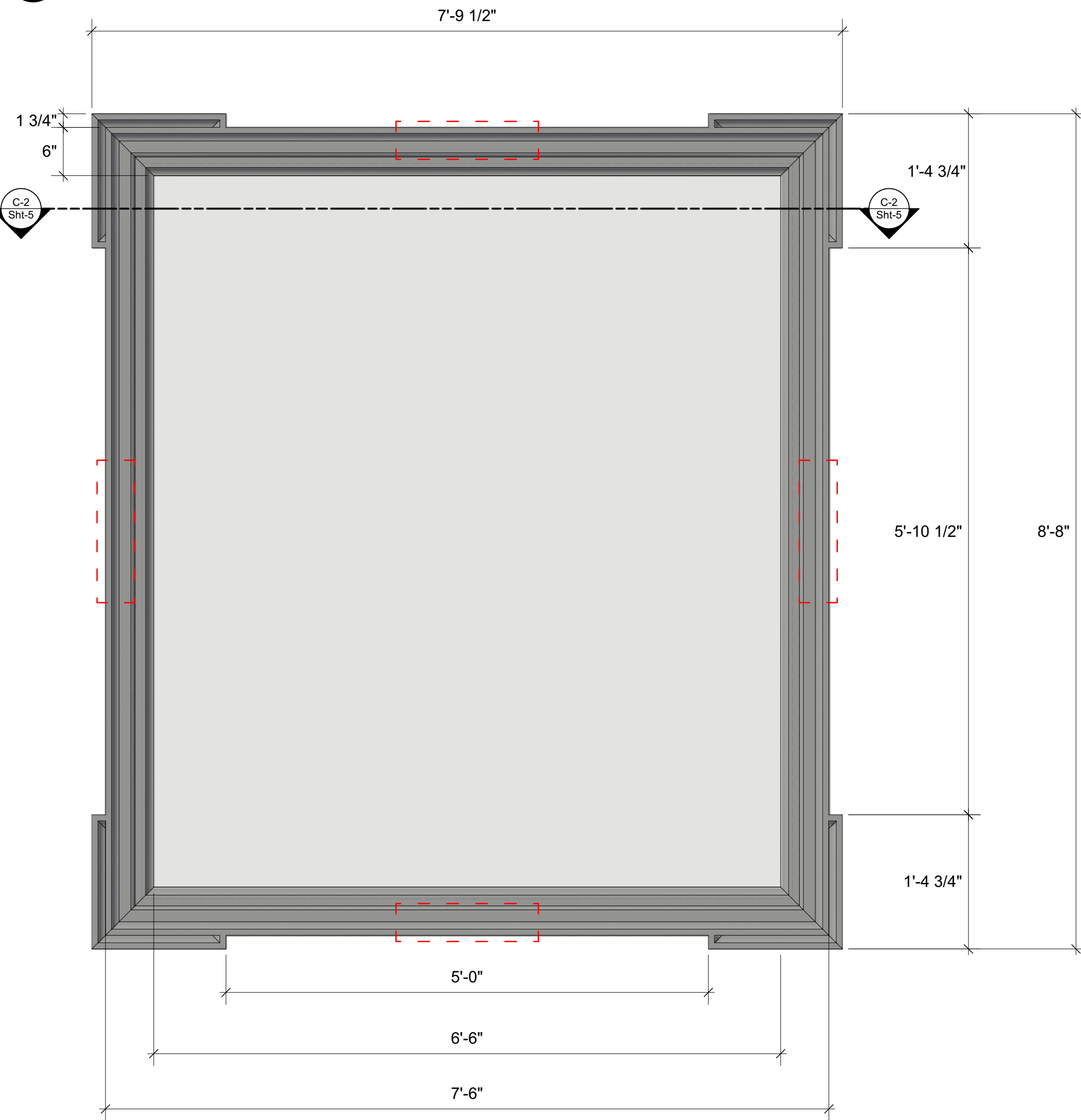

**NOTE:**

- See the reference. It is designed based on the reference.
- It doesn't have to be the actual molding for the frame but it can be built with the regular lumber/luan.
- Lining would be great without detailed patterns.
- Order four carved onlays below at amazon or similar substitutes: \$15.99 x 4 = \$63.96
- Apply four carved onlays (17.72" x 4.72") at the center of the frame, all four sides.
- The portrait will be painted on the muslin inside the frame.

**reference**



**C-2 Portrait: section**

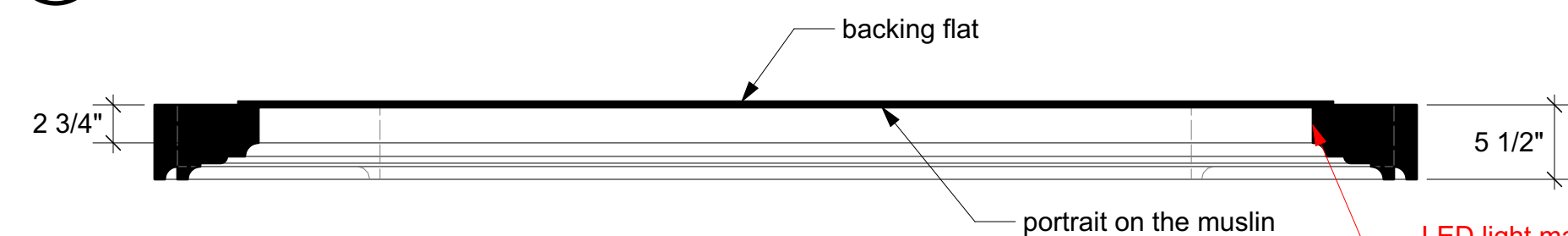

LED light may be installed around the frame:  
consult with a Lighting designer



Figure 1: Wood carved onlay decoration: 17.72" x 4.72"

*Witch*  
by Jen Silverman

Directing: Tyler Christie  
Lighting: Meredith Brown  
Sound: Liz Atkinson  
Costume: Andrew Burns  
Tech Directing: TBA  
Scenic: Inseung Park  
Drafting: Inseung Park

The Winnepesaukee Playhouse

Portrait

Scale:

1"=1'-0"

Date:

April 25, 2024



S.D. 13829  
SCENIC DESIGNER

SIGNATURE *[Signature]*

**D-1 Tree: front**

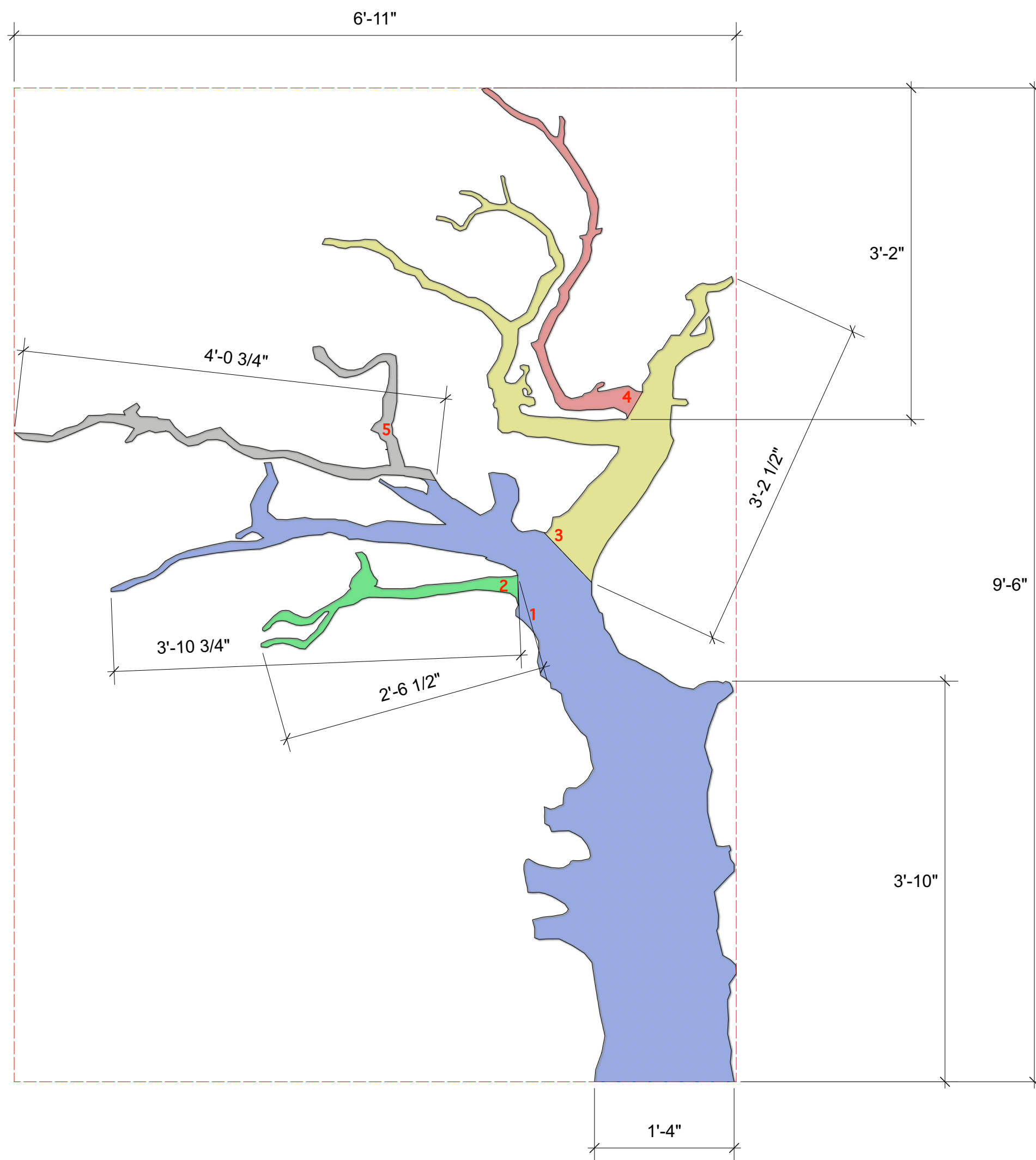

**NOTE:**

- 5 pieces of tree parts: 1 through 5
- relatively flat unit in a minimal 3 dimensionality: The tree unit will be most upstage, see the floor plan
- cut out the shape of each branch unit out of luan or plywood, then apply the chicken wire to give a volum, and cover with crumpled brown crafting paper for tree texture
- The whole tree is about 7' wide 9'-6" tall
- The tree is about 3" to 6" thick in depth including all materials (wooden structure, wire, and paper)

**Reference**

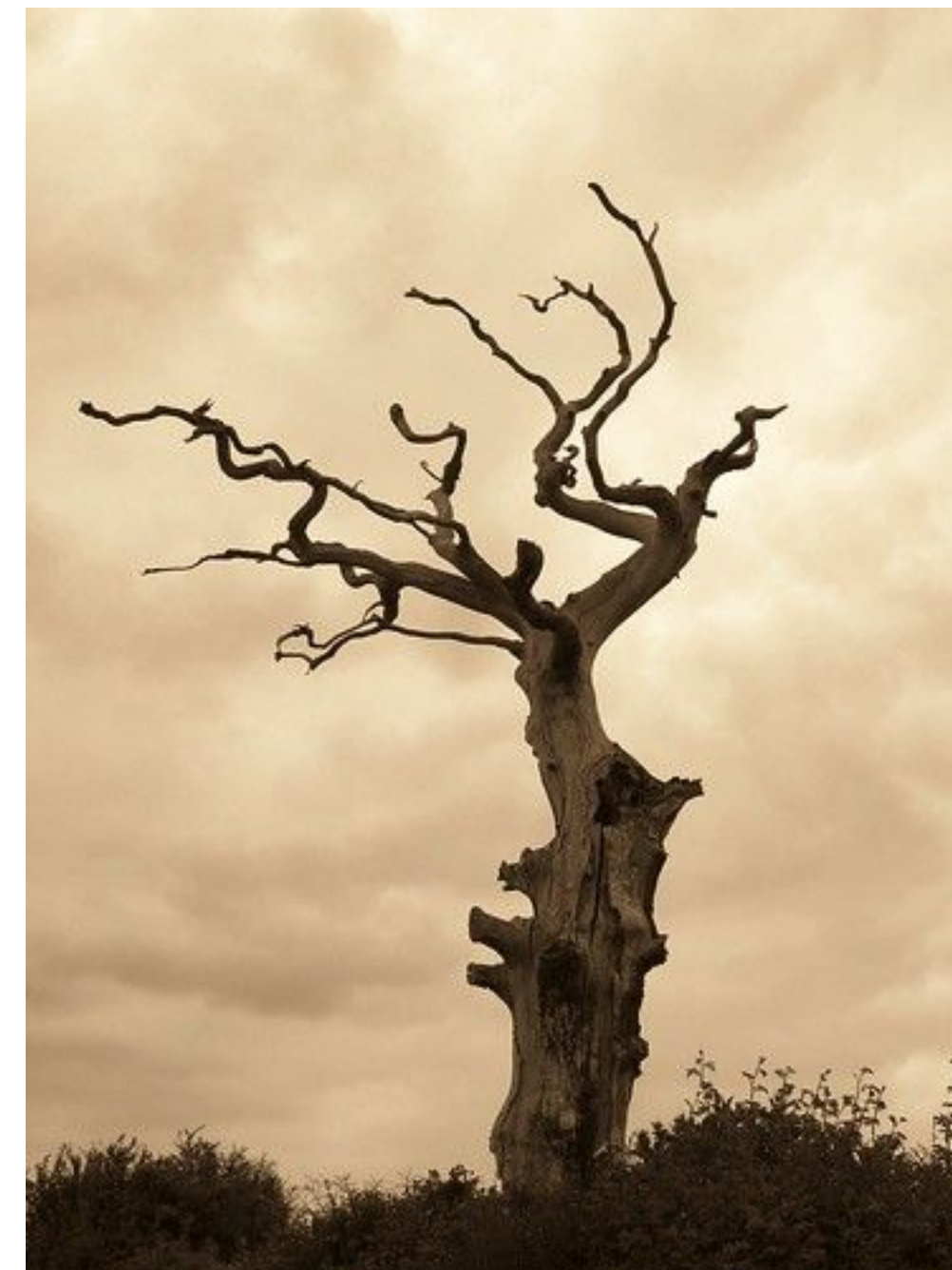

**D-2 Tree: plan**



*Witch*

by Jen Silverman

Directing: Tyler Christie  
 Lighting: Meredith Brown  
 Sound: Liz Atkinson  
 Costume: Andrew Burns  
 Tech Directing: TBA  
 Scenic: Inseung Park  
 Drafting: Inseung Park

**The Winnepesaukee Playhouse**

**Tree**

**Scale:**

1"=1'-0"

**Date:**

April 25, 2024



S.D. 13829  
 SCENIC DESIGNER

SIGNATURE *[Signature]*

**A-1 Banquet table: front**



**A-2 Banquet table: plan**

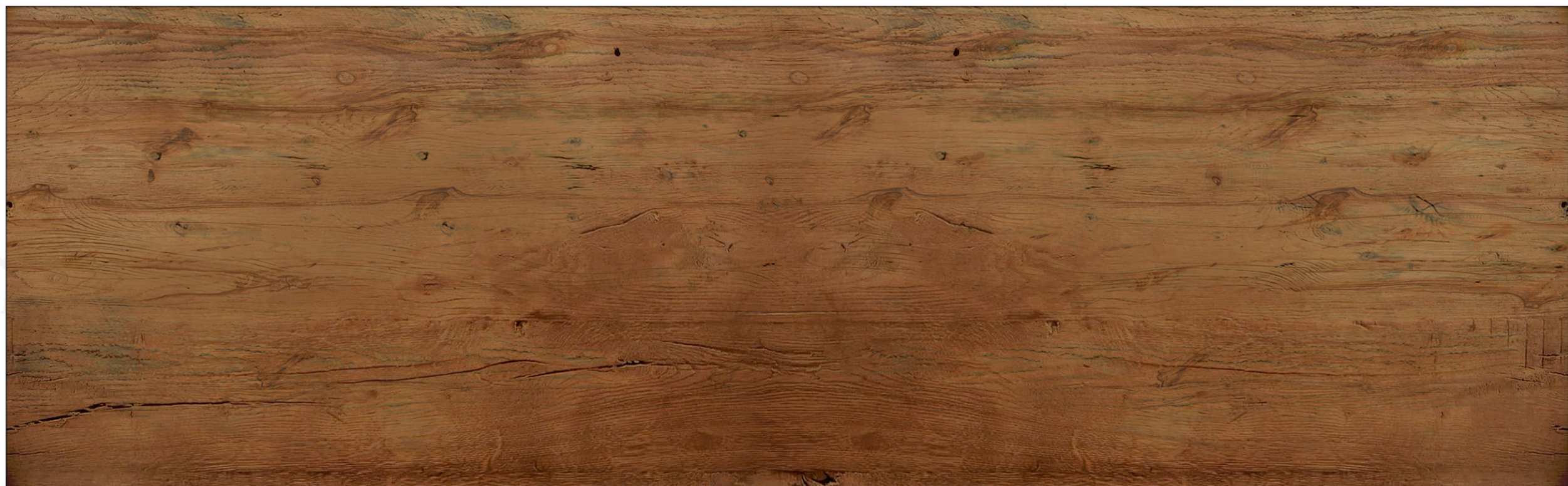

**NOTE:**  
 - See reference  
 - The table top is dark pine (lighter than legs and stretcher),  
 legs and stretcher are oak antique (darker), even darker (see reference)  
 - wood satin finish

**Reference**



**Witch**  
 by Jen Silverman

Directing: Tyler Christie  
 Lighting: Meredith Brown  
 Sound: Liz Atkinson  
 Costume: Andrew Burns  
 Tech Directing: TBA  
 Scenic: Inseung Park  
 Drafting: Inseung Park

**The Winnepesaukee Playhouse**

**Paint Elevation:  
 Banquet Table**

**Scale:**  
 1"=1'-0"

**Date:**  
 April 25, 2024



S.D. 13829  
 SCENIC DESIGNER  
 SIGNATURE *Jen Silverman*

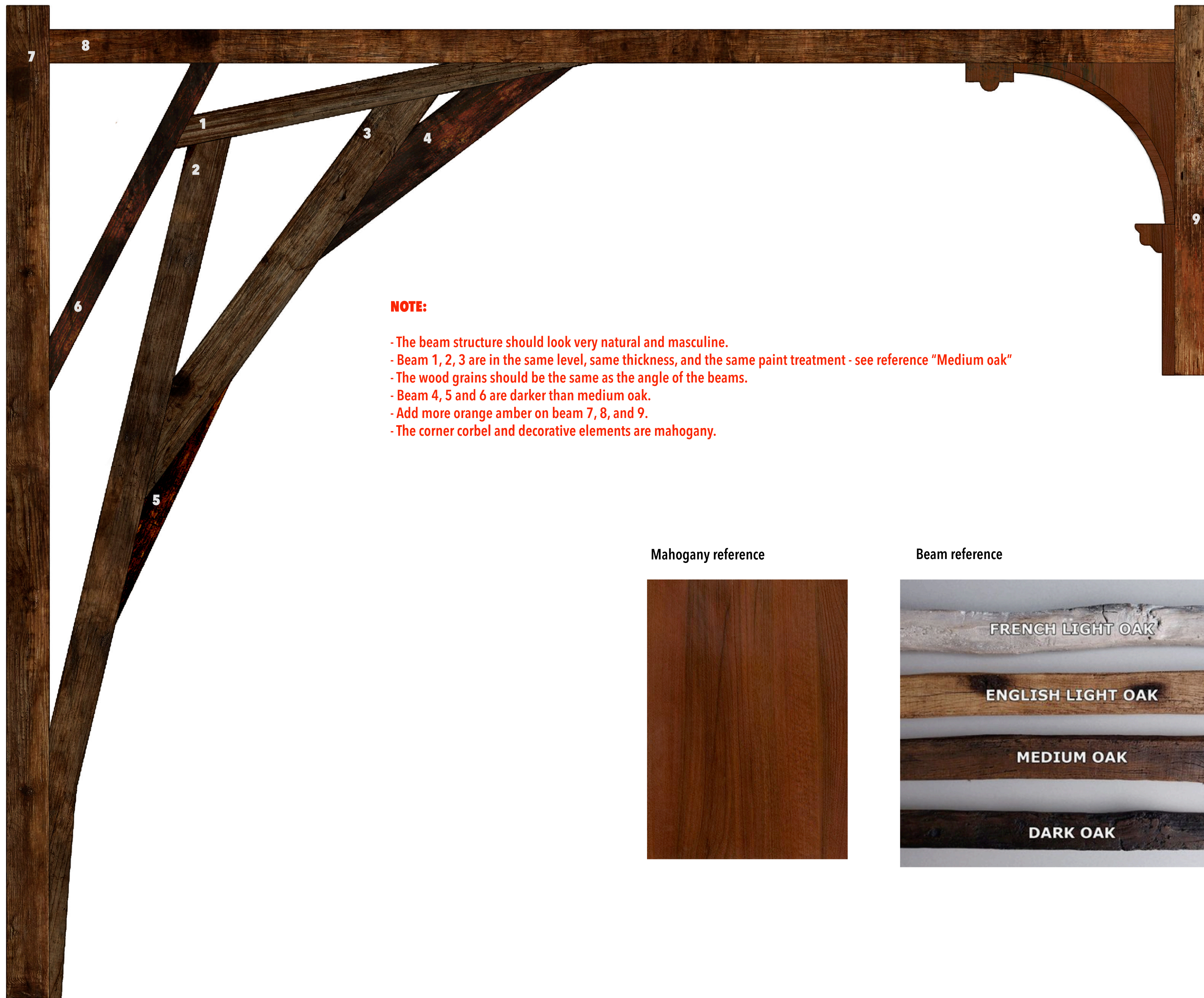

**NOTE:**

- The beam structure should look very natural and masculine.
- Beam 1, 2, 3 are in the same level, same thickness, and the same paint treatment - see reference "Medium oak"
- The wood grains should be the same as the angle of the beams.
- Beam 4, 5 and 6 are darker than medium oak.
- Add more orange amber on beam 7, 8, and 9.
- The corner corbel and decorative elements are mahogany.

Mahogany reference

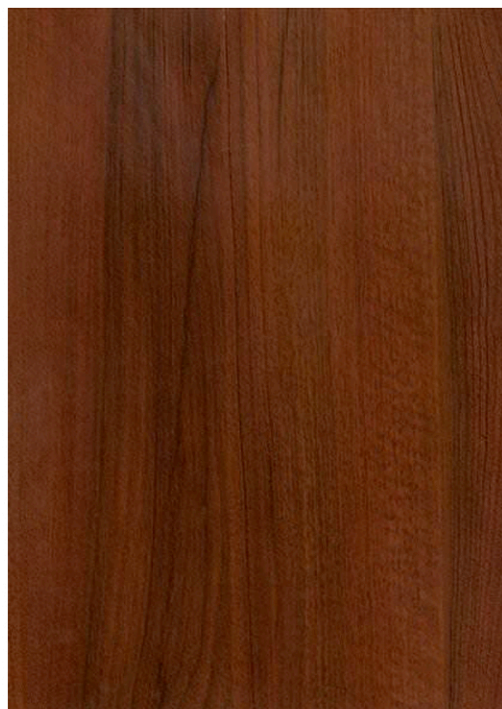

Beam reference



*Witch*

by Jen Silverman

Directing: Tyler Christie  
 Lighting: Meredith Brown  
 Sound: Liz Atkinson  
 Costume: Andrew Burns  
 Tech Directing: TBA  
 Scenic: Inseung Park  
 Drafting: Inseung Park

The Winnepesaukee Playhouse

Paint Elevation:  
 Castle arch

Scale:

3/4"=1'-0"

Date:

April 25, 2024



S.D. 13829  
 SCENIC DESIGNER

SIGNATURE *Inseung Park*





**NOTE:**

- The portrait frame is antique gold: see reference
- The portrait is Jacobean style, 1600s.

**reference**



# Witch

by Jen Silverman

Directing: Tyler Christie  
 Lighting: Meredith Brown  
 Sound: Liz Atkinson  
 Costume: Andrew Burns  
 Tech Directing: TBA  
 Scenic: Inseung Park  
 Drafting: Inseung Park

**The Winnepesaukee Playhouse**

**Paint Elevation:  
Portrait**

**Scale:**

1-1/2"=1'-0"

**Date:**

April 25, 2024



S.D. 13829  
 SCENIC DESIGNER

SIGNATURE *Jen Silverman*

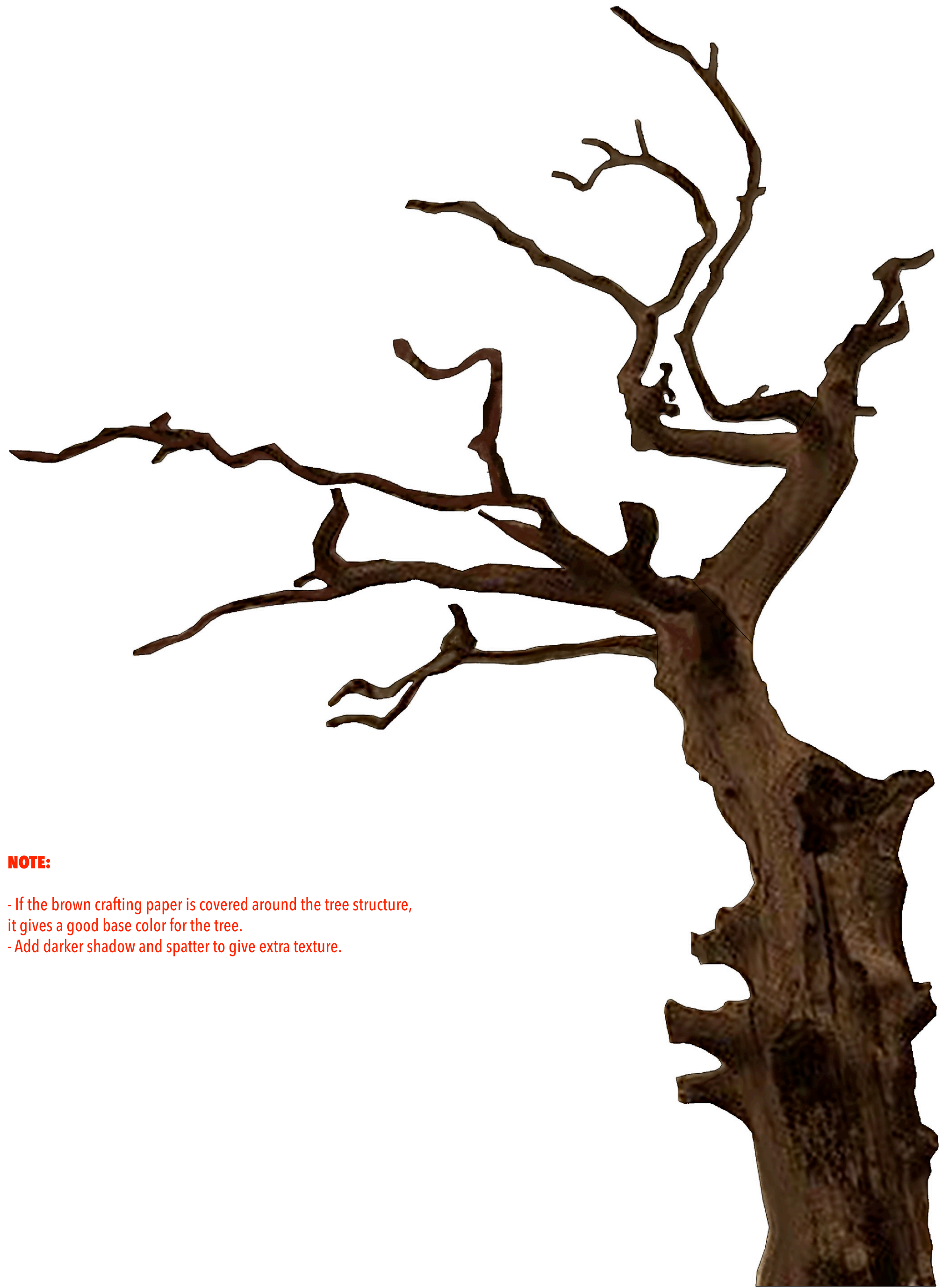

**NOTE:**  
- If the brown crafting paper is covered around the tree structure, it gives a good base color for the tree.  
- Add darker shadow and spatter to give extra texture.

Reference



**Witch**  
by Jen Silverman

Directing: Tyler Christie  
Lighting: Meredith Brown  
Sound: Liz Atkinson  
Costume: Andrew Burns  
Tech Directing: TBA  
Scenic: Inseung Park  
Drafting: Inseung Park

The Winnepesaukee Playhouse

Tree

Scale:  
1-1/2" = 1'-0"

Date:  
April 25, 2024



S.D. 13829  
SCENIC DESIGNER  
SIGNATURE *Jen Silverman*

# Witch

by Jen Silverman

Directing: Tyler Christie  
Lighting: Meredith Brown  
Sound: Liz Atkinson  
Costume: Andrew Burns  
Tech Directing: TBA  
Scenic: Inseung Park  
Drafting: Inseung Park

## The Winnepesaukee Playhouse

Paint elevation:  
Floor

### Scale:

$\frac{3}{8}'' = 1'-0''$

### Date:

April 25, 2024



S.D. 13829  
SCENIC DESIGNER

SIGNATURE *Inseung Park*

