

Snow White and The Seven Dorks
by Adam Day Howard

Creative Team:

Directing: Kenn McLaughlin
Costume Design: Leah Smith
Lighting Design: Jared Gooding
Prop: Jodi Bobrovsky
Music directing: Steven Jones
Choreographer: Harrison Guy
Technical Directing: Joel Burkholder
Scenic Design: Inseung Park
Drafting: Inseung Park

Stages Repetory Theatre

Title:

Ground Plan (castle)

Scale:

1/2" = 1'-0"

Date:

Sep 5, 2022



S.D. 13829
SCENIC DESIGNER

SIGNATURE *Inseung Park*

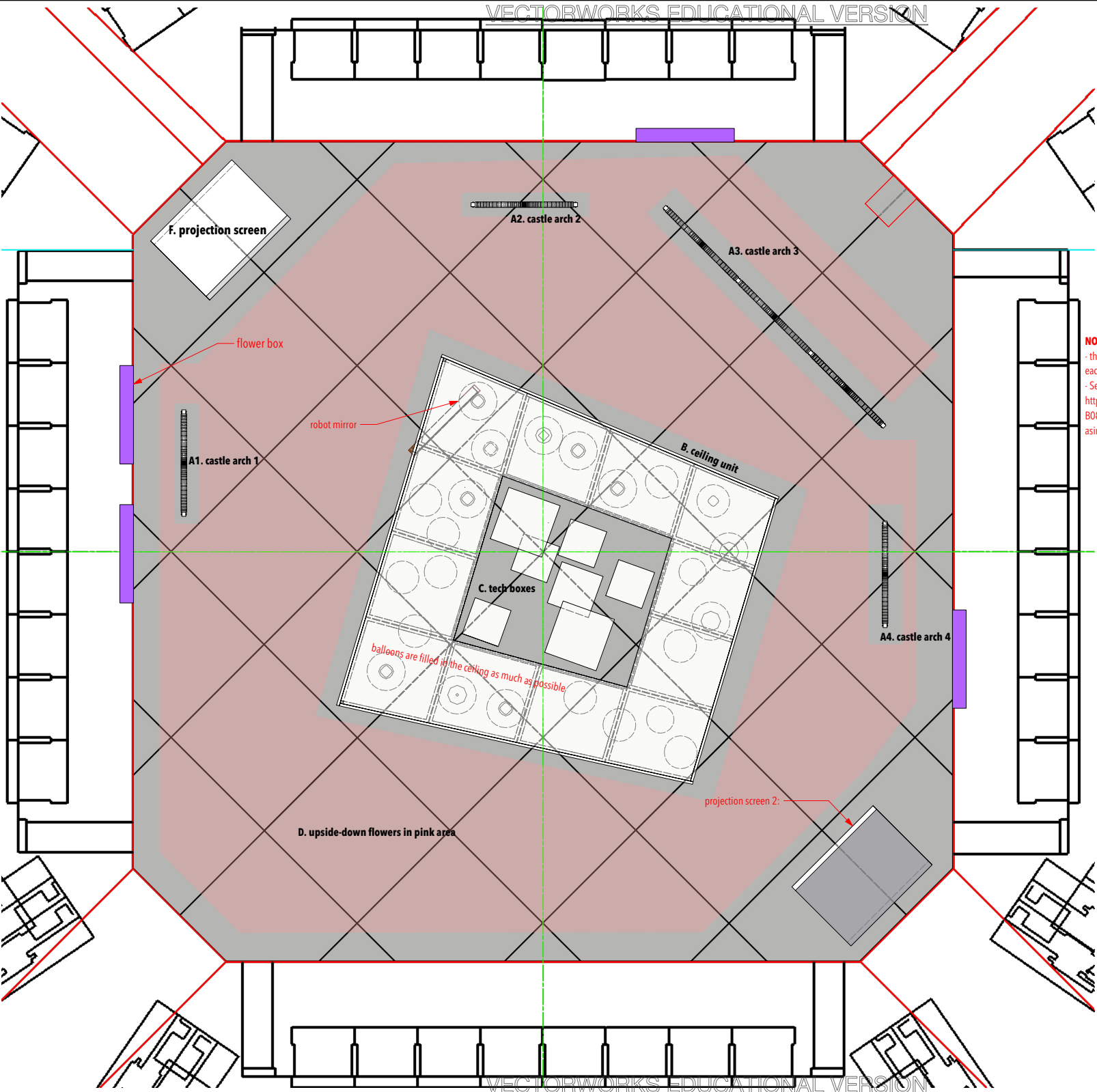

NOTE:
- the floor is high glassy black: each square is 4'x4'
- See Black Gloss Bulk roll Vinyl wrap roll https://www.amazon.com/gp/product/B08GL327DG/ref=ppx_yo_dt_b_search_asin_title?ie=UTF8&th=1

Snow White and The Seven Dorks
by Adam Day Howard

Creative Team:

- Directing: Kenn McLaughlin
- Costume Design: Leah Smith
- Lighting Design: Jared Gooding
- Prop: Jodi Bobrovsky
- Music directing: Steven Jones
- Choreographer: Harrison Guy
- Technical Directing: Joel Burkholder
- Scenic Design: Inseung Park
- Drafting: Inseung Park

Stages Repertory Theatre

Title:

Ground Plan (forest)

Scale:

1/2" = 1'-0"

Date:

Sep 5, 2022



S.D. 13829
SCENIC DESIGNER

SIGNATURE *Inseung Park*

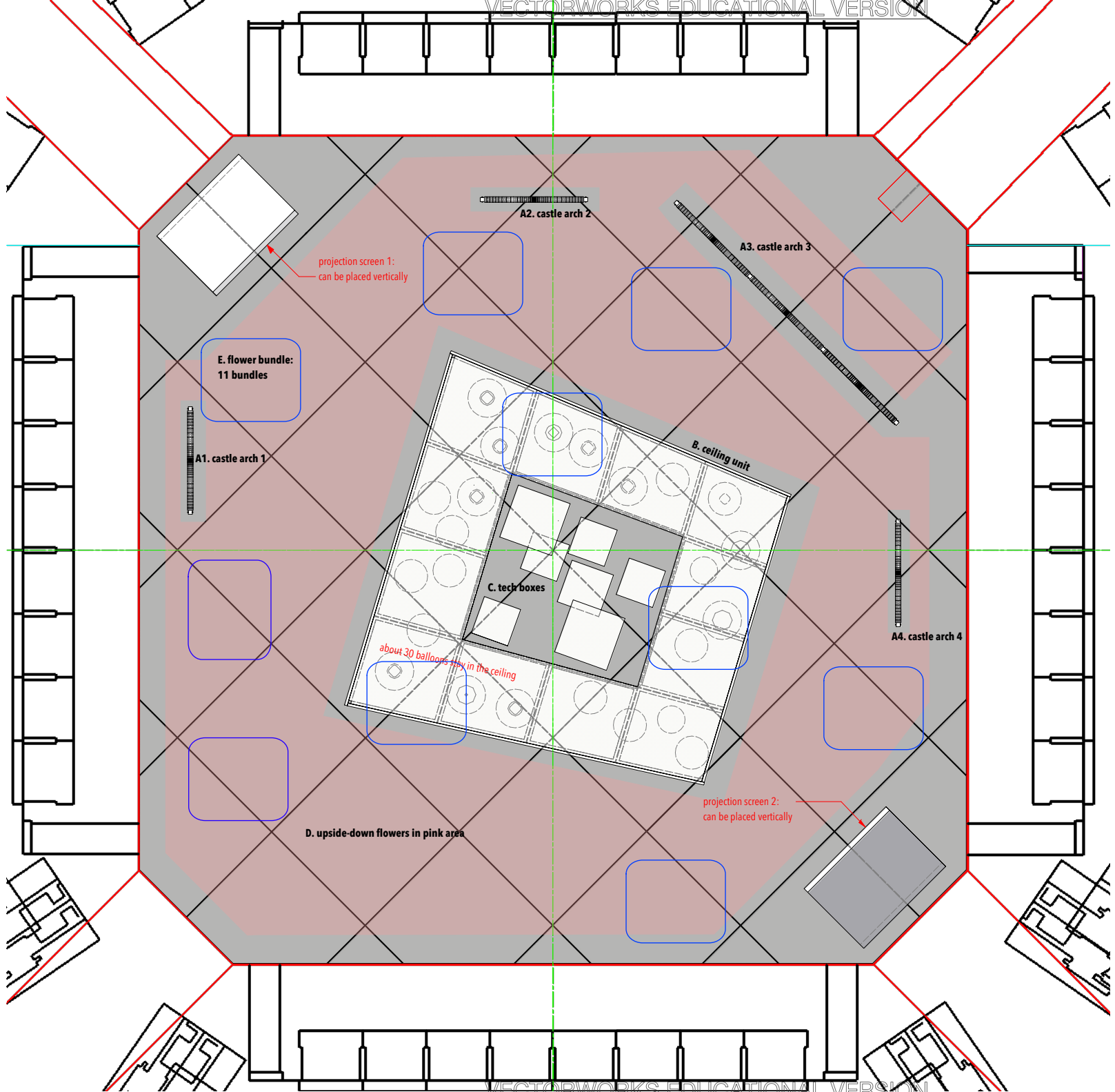

Snow White and The Seven Dorks
by Adam Day Howard

Creative Team:

Directing: Peter Ton
Costume Design: Jaymee Ngernwicht
Lighting Design: Janessa A. Harris
Prop: Jodi Bobrovsky
Sound Design: Isaiah Parnell
Technical Directing: Joel Burkholder
Scenic Design: Inseung Park
Drafting: Inseung Park

Stages Repertory Theatre

Title:

Section: SOUTH

Scale:

1/4" = 1'-0"

Date:

Sep 5, 2022



S.D. 13829
SCENIC DESIGNER

SIGNATURE *[Signature]*

Section:
- section looking toward South

ROOF
32' - 0"

TECHNICAL LEVEL
21' - 0"

LEVEL 02
12' - 0"

LEVEL 01
0' - 0"

ceiling flowers hanged about 13' off the floor
24' wide x 5' tall yellow highlight area

13'-0"

⊕

A1-1 Castle arch 1: front

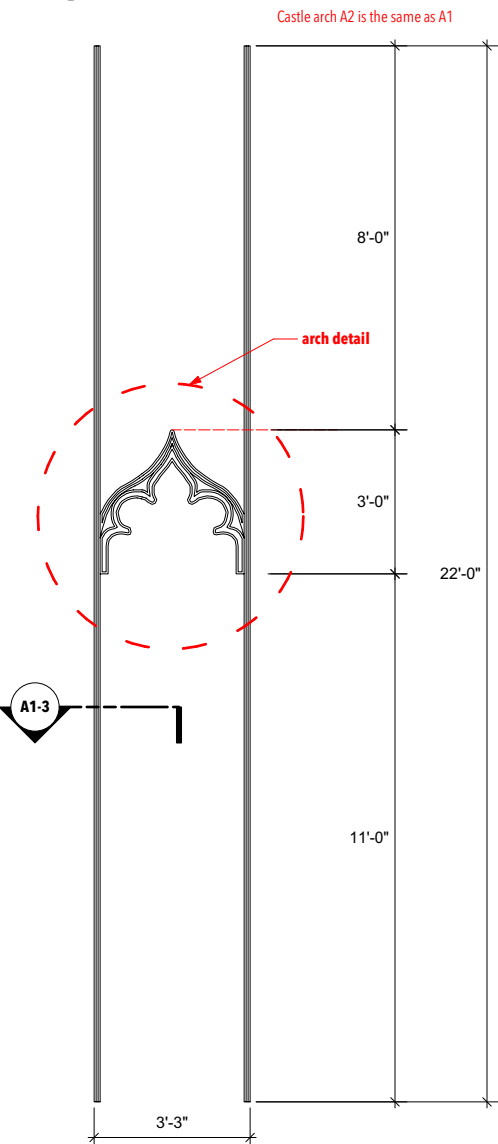

A1-2 Castle arch 1: plan



A1-3 Castle arch post: section detail

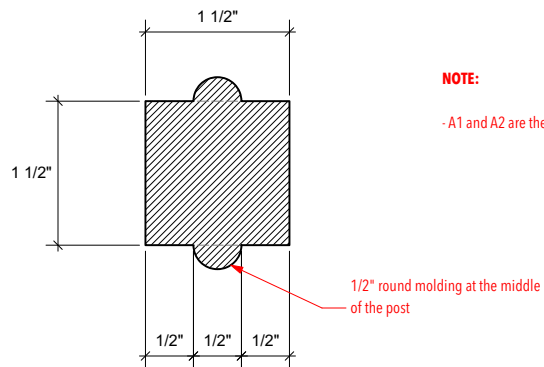

A1-4 Castle arch: front detail

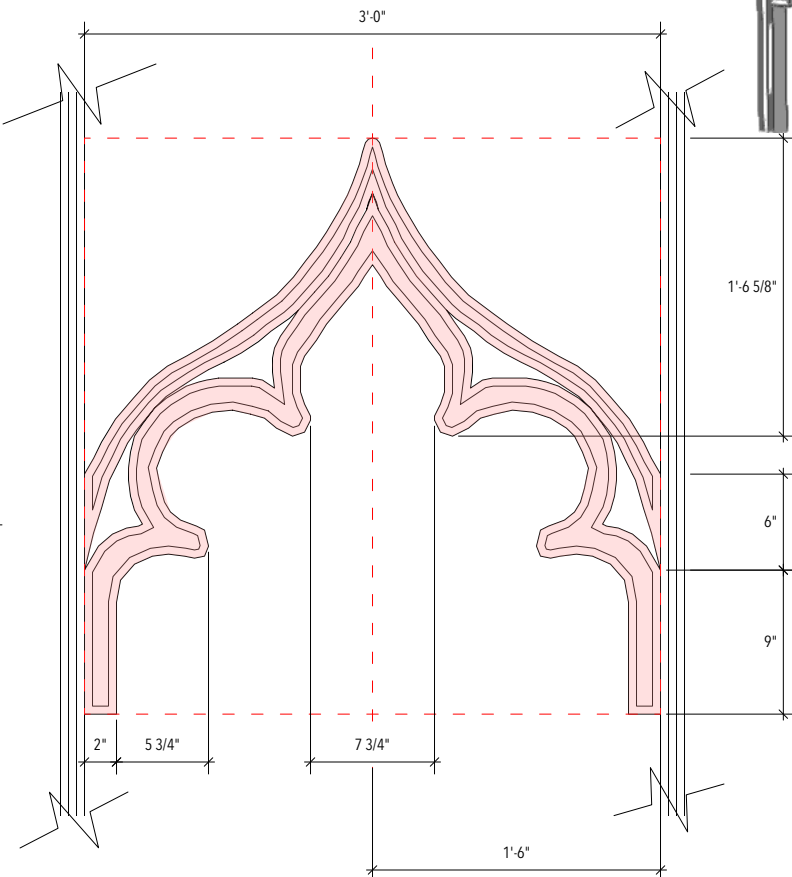

A1-5 Castle arch: perspective

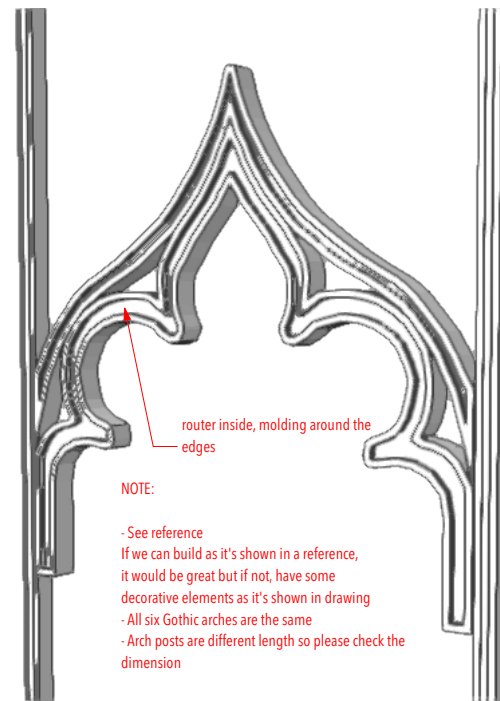

reference



Snow White and The Seven Dorks
by Adam Day Howard

Creative Team:

- Directing: Kenn McLaughlin
- Costume Design: Leah Smith
- Lighting Design: Jared Gooding
- Prop: Jodi Bobrovsky
- Music directing: Steven Jones
- Choreographer: Harrison Guy
- Technical Directing: Joel Burkholder
- Scenic Design: Inseung Park
- Drafting: Inseung Park

Stages Repertory Theatre

Title:

Castle arch A1

Scale:

1/2" = 1'-0"

Date:

Sep 5, 2022



S.D. 13829
SCENIC DESIGNER

SIGNATURE *Inseung Park*

A3-1 Castle arch 3: front

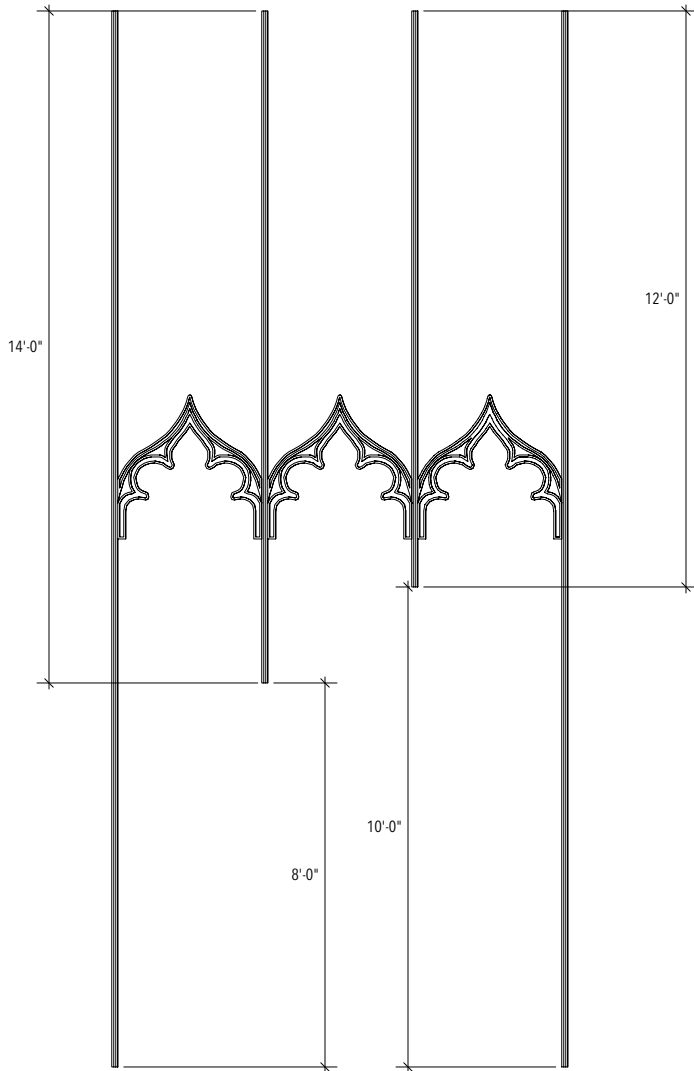

A4-1 Castle arch 4: front

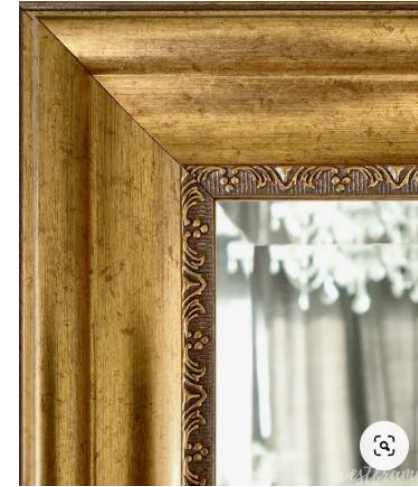
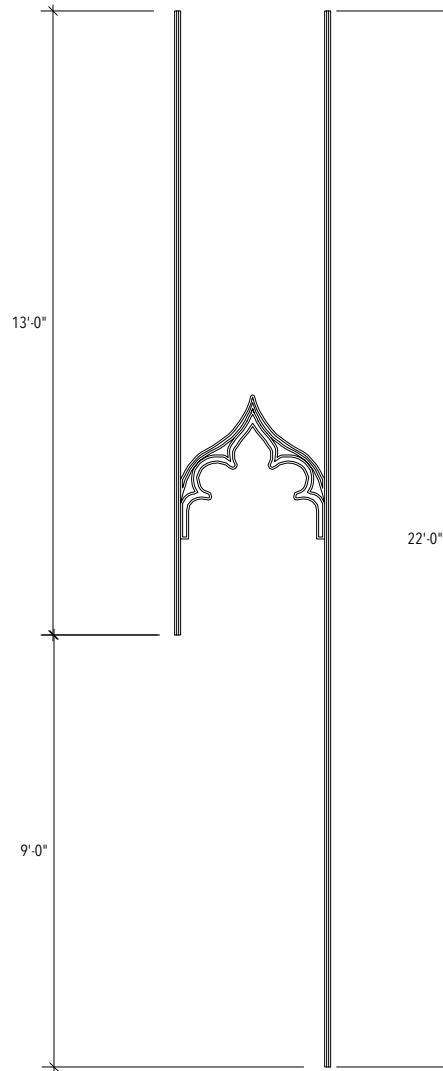

NOTE:

- the color scheme is gold above: use metallic gold as a basic then add more aging with darker sienna or van dyke brown

Snow White and The Seven Dorks
by Adam Day Howard

Creative Team:

- Directing: Kenn McLaughlin
- Costume Design: Leah Smith
- Lighting Design: Jared Gooding
- Prop: Jodi Bobrovsky
- Music directing: Steven Jones
- Choreographer: Harrison Guy
- Technical Directing: Joel Burkholder
- Scenic Design: Inseung Park
- Drafting: Inseung Park

Stages Repetory Theatre

Title:

Castle arch A3, 4

Scale:

1/2" = 1'-0"

Date:

Sep 5, 2022



S.D. 13829
SCENIC DESIGNER

SIGNATURE *Inseung Park*

B-1 Ceiling: front

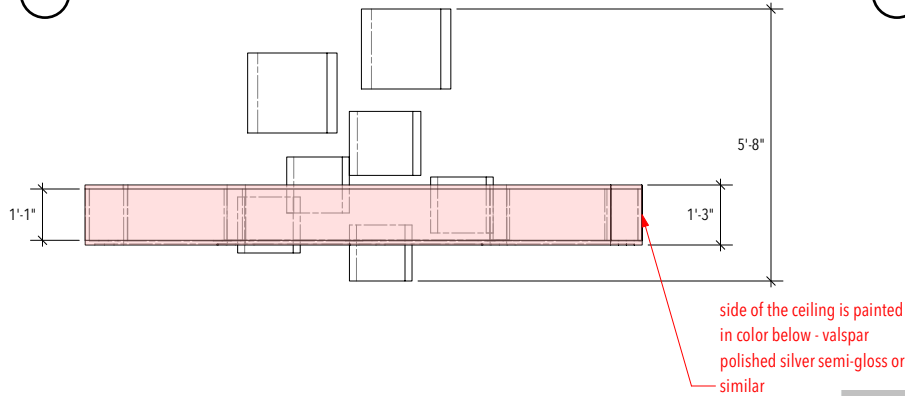

B-4 Ceiling: perspective bottom

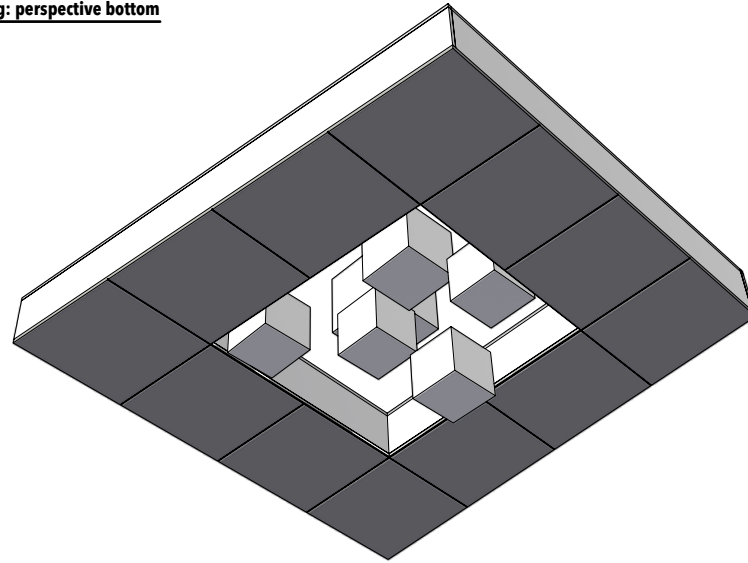

side of the ceiling is painted in color below - valspar polished silver semi-gloss or similar



B-2 Ceiling: plan
Scale: 3/4"=1'-0"

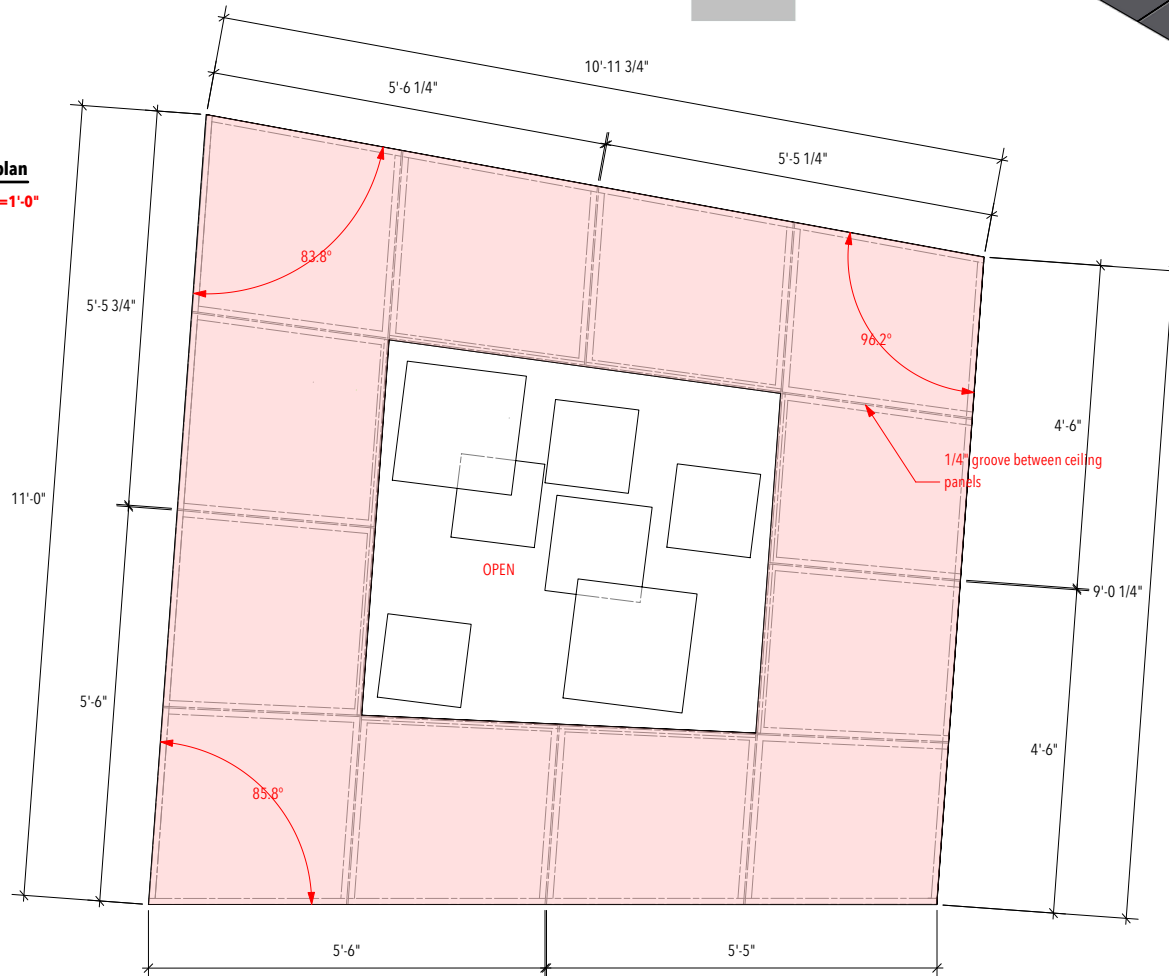

NOTE:

- the top part of the ceiling is a solid unit
- the bottom part of the ceiling has tile grooves, frosted white plexi-glass material
- find the center point of each side, then find another center point for each half side to determine the dimension of each tile
- the ceiling unit is a stationary unit: stay in the same height
- tech boxes are the flying unit that fly in/out through the mid trapezoid hole
- the balloons are installed in the ceiling unit
- the bottom part of the ceiling should be lowered to spill the balloon inside for the finale at the end

Snow White and The Seven Dorks
by Adam Day Howard

Creative Team:

- Directing: Kenn McLaughlin
- Costume Design: Leah Smith
- Lighting Design: Jared Gooding
- Prop: Jodi Bobrovsky
- Music directing: Steven Jones
- Choreographer: Harrison Guy
- Technical Directing: Joel Burkholder
- Scenic Design: Inseung Park
- Drafting: Inseung Park

Stages Repetory Theatre

Title:

Ceiling

Scale:

1/2"=1'-0"

Date:

Sep 5, 2022



S.D. 13829
SCENIC DESIGNER

SIGNATURE *Inseung Park*

C-1 Tech Boxes: front

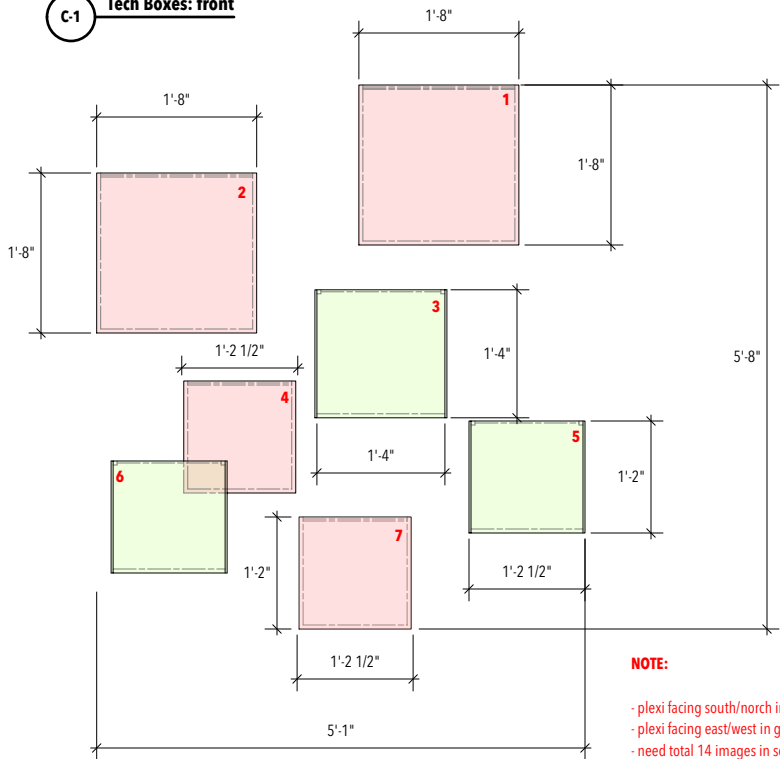

C-3 Tech Boxes: Right

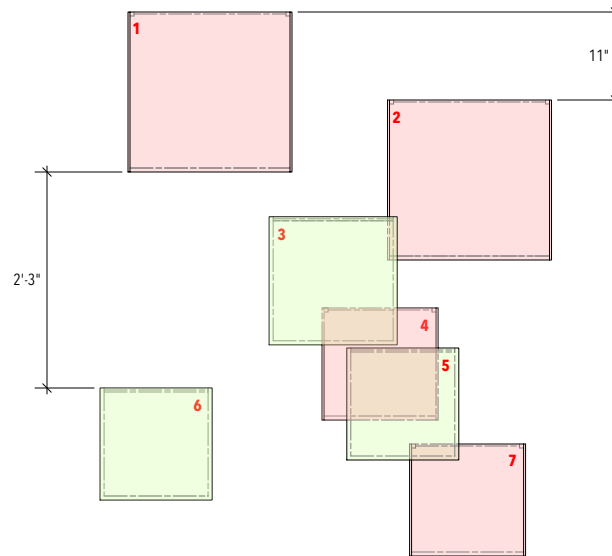

NOTE:

- plexi facing south/north in pink
- plexi facing east/west in green
- need total 14 images in seven tech boxes:
- two images in each box, two images can be the same
- the bottom part of the boxes is the plexi-glass material without images
- the surface that doesn't include an image is a solid material: paint in color below



color swatch: valspar - polished silver 4008-1B, semi gloss

C-2 Tech Boxes: plan

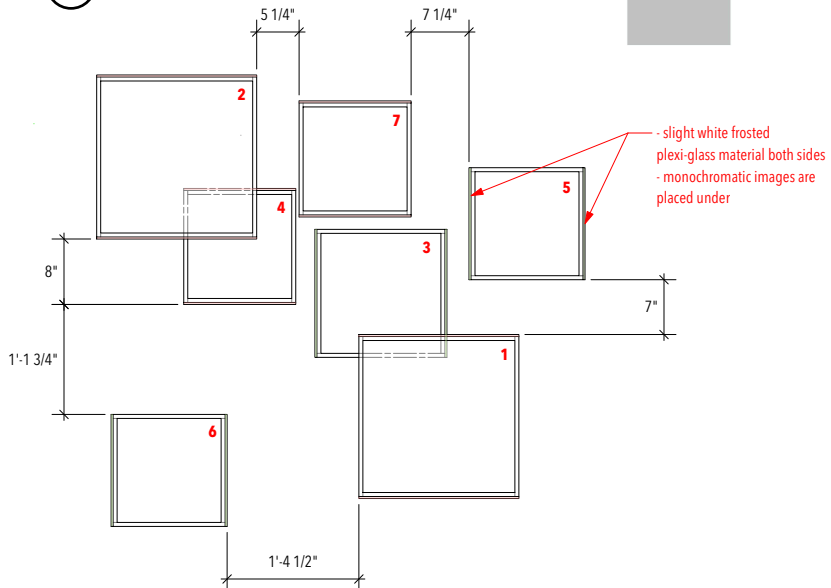

- slight white frosted plexi-glass material both sides
- monochromatic images are placed under

C-4 Tech Boxes: perspective

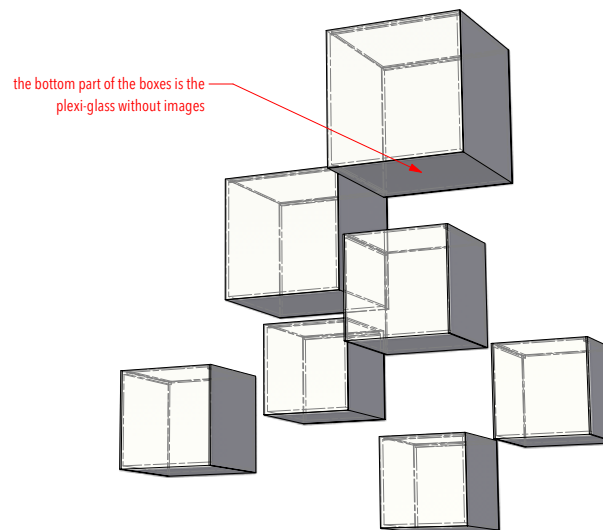

Snow White and The Seven Dorks
by Adam Day Howard

Creative Team:

- Directing: Kenn McLaughlin
- Costume Design: Leah Smith
- Lighting Design: Jared Gooding
- Prop: Jodi Bobrovsky
- Music directing: Steven Jones
- Choreographer: Harrison Guy
- Technical Directing: Joel Burkholder
- Scenic Design: Inseung Park
- Drafting: Inseung Park

Stages Repertory Theatre

Title:

tech boxes

Scale:

1"=1'-0"

Date:

Sep 5, 2022



S.D. 13829
SCENIC DESIGNER

SIGNATURE *Inseung Park*

5-1

tech box 1

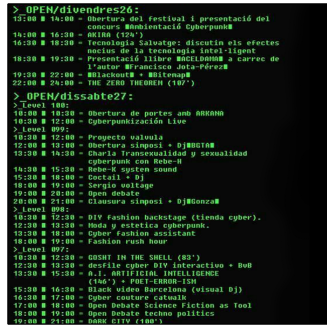

tech box 2

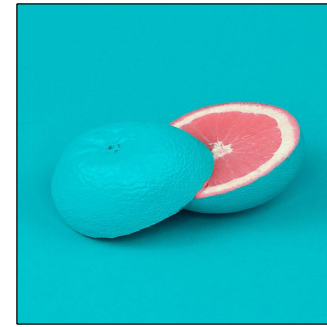

tech box 3



tech box 4

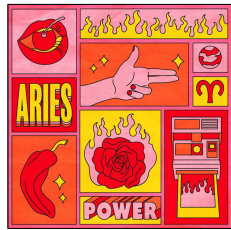

tech box 5

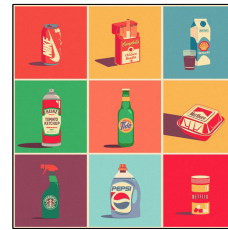

tech box 6

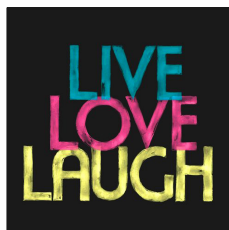
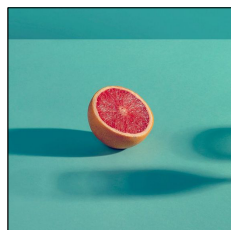

tech box 7

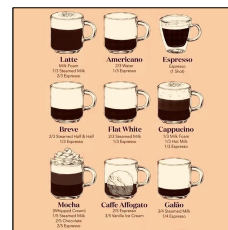

Snow White and The Seven Dorks
by Adam Day Howard

Creative Team:

- Directing: Kenn McLaughlin
- Costume Design: Leah Smith
- Lighting Design: Jared Gooding
- Prop: Jodi Bobrovsky
- Music directing: Steven Jones
- Choreographer: Harrison Guy
- Technical Directing: Joel Burkholder
- Scenic Design: Inseung Park
- Drafting: Inseung Park

Stages Repertory Theatre

Title:

tech box images

Scale:

2"=1'-0"

Date:

Sep 5, 2022



S.D. 13829
SCENIC DESIGNER

SIGNATURE *[Signature]*

5-2

NOTE:

- see a reference
- artificial flowers are hung upside-down
- red, yellow, pink, white roses are good: would be ok with alternative
- green leaves and stems are included
- every foot interval between flowers or bundles of flowers
- each flower stem is about 14" to 18", hung naturally
- see the section for height: drawing #2 - about 5' tall, 13' off the floor

D Ceiling flowers: plan

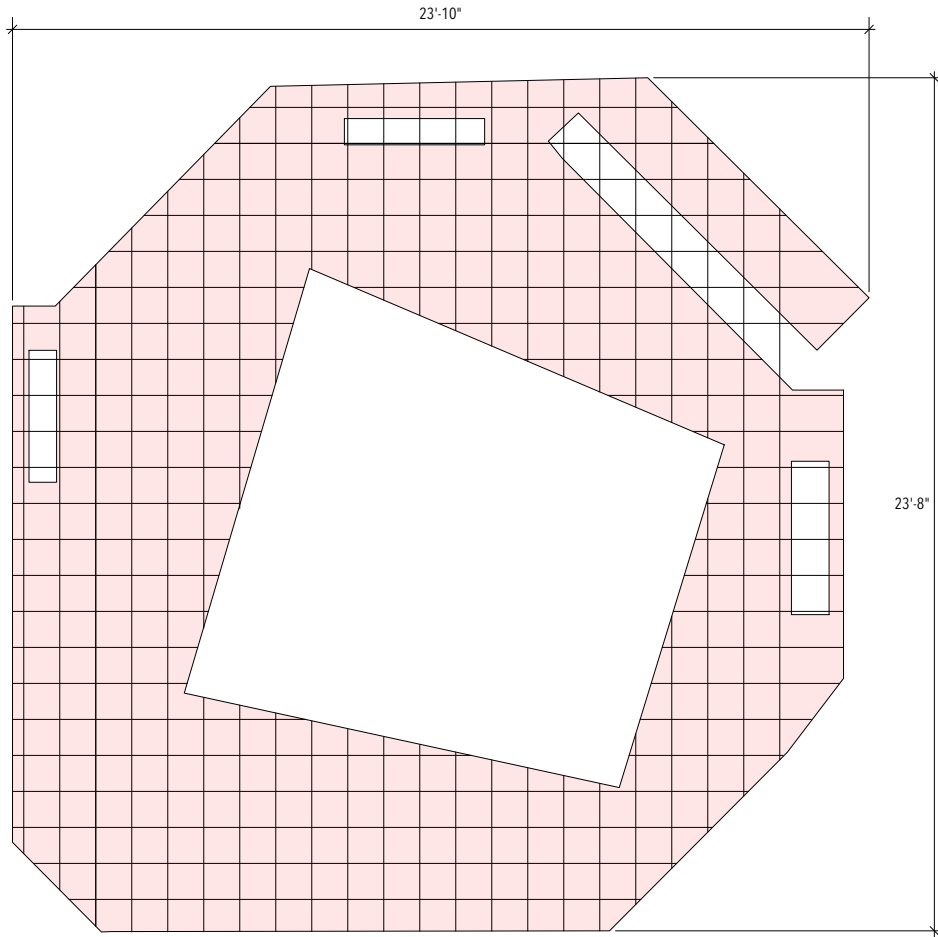

Snow White and The Seven Dorks

by Adam Day Howard

Creative Team:

Directing: Kenn McLaughlin

Costume Design: Leah Smith

Lighting Design: Jared Gooding

Prop: Jodi Bobrovsky

Music directing: Steven Jones

Choreographer: Harrison Guy

Technical Directing: Joel Burkholder

Scenic Design: Inseung Park

Drafting: Inseung Park

Stages Repetory Theatre

Title:

upside-down flowers

Scale:

1/2" = 1'-0"

Date:

Sep 5, 2022



S.D. 13829
SCENIC DESIGNER

SIGNATURE *Inseung Park*

E forest flowers: front

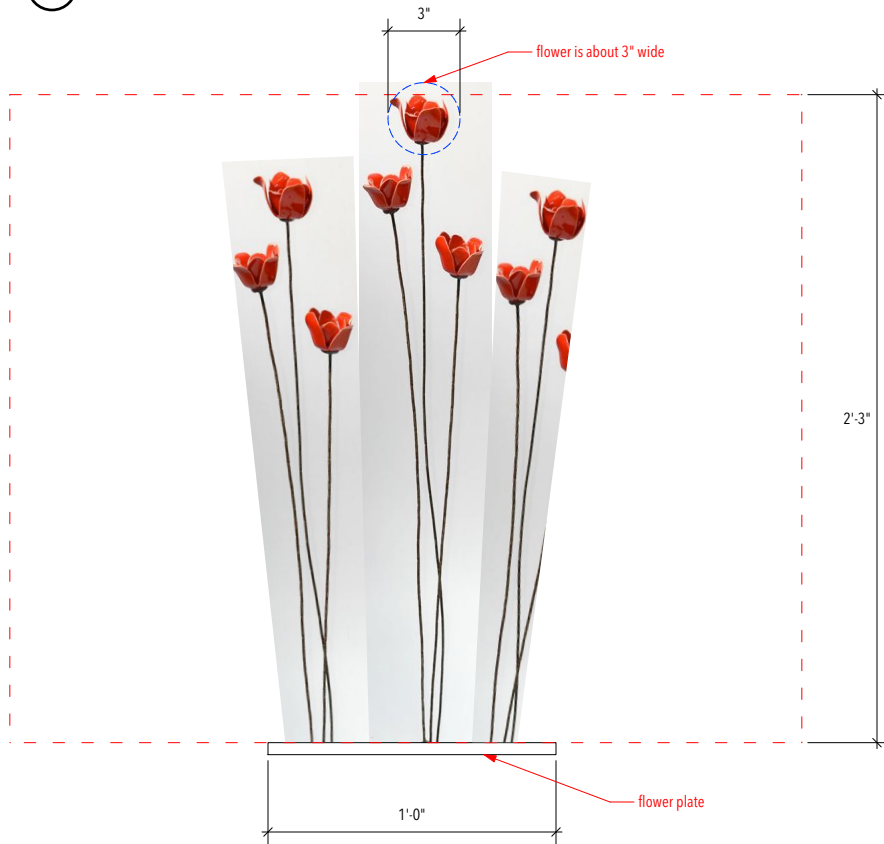

NOTE:

- see a reference
- the same kinds of flowers as the ceiling flowers
- red, yellow, pink, white roses are good: would be ok with alternative
- green leaves and stems are included
- each flower stem is about 16" to 27": if the flower is too short, extend with some steel rod
- each flower is about 4" diameter: bigger is good
- about 6-7 flowers are mounted on a plate (1'x1')
- each flower plate covered by the same black glossy material for the floor
- 11 bundles of flowers are needed to be enough for the floor in Enchanted forest scene

Snow White and The Seven Dorks

by Adam Day Howard

Creative Team:

- Directing: Kenn McLaughlin
- Costume Design: Leah Smith
- Lighting Design: Jared Gooding
- Prop: Jodi Bobrovsky
- Music directing: Steven Jones
- Choreographer: Harrison Guy
- Technical Directing: Joel Burkholder
- Scenic Design: Inseung Park
- Drafting: Inseung Park

Stages Repetory Theatre

Title:

upside-down flowers

Scale:

1/2" = 1'-0"

Date:

Sep 5, 2022



S.D. 13829
SCENIC DESIGNER

SIGNATURE *Inseung Park*

F-1 Mirror: front

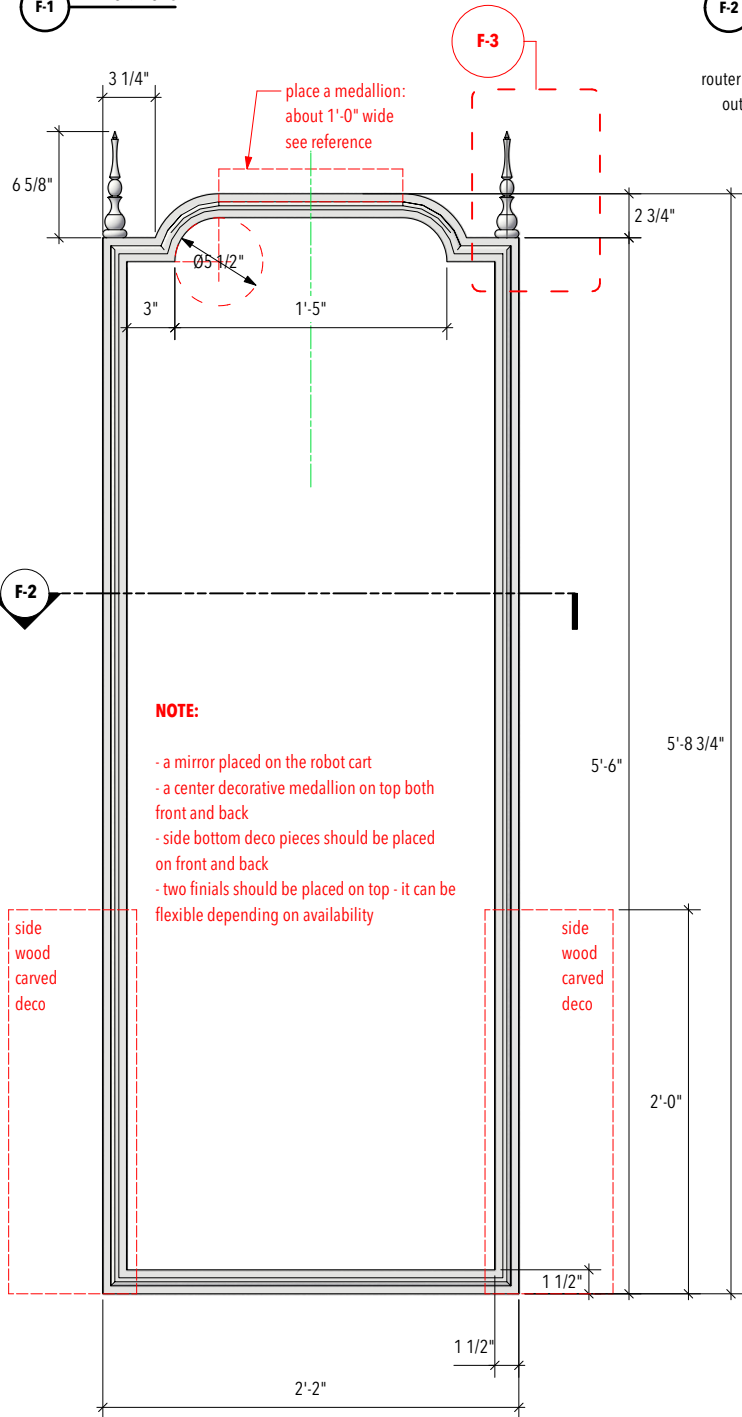

F-2 Mirror: section
scale: full life scale 1:1

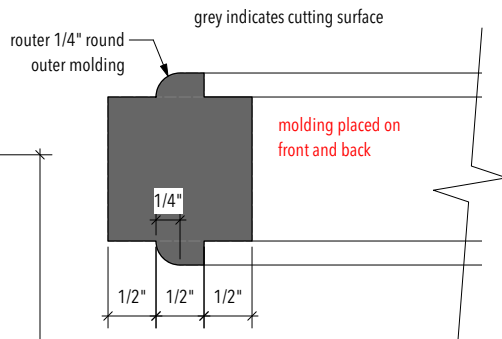

reference 1: wood carved medallion



reference 2: wood carved deco on the bottom side

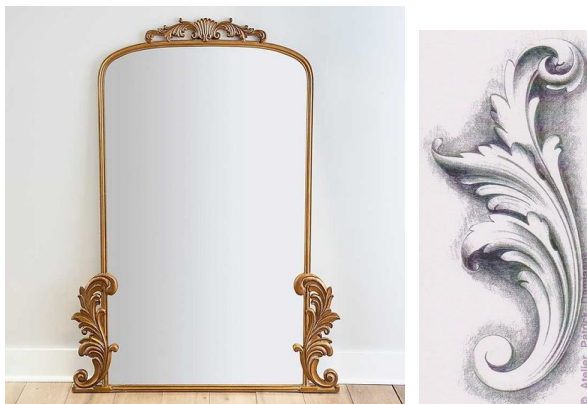

F-3 Mirror finial: detail
scale: full life scale 1:1

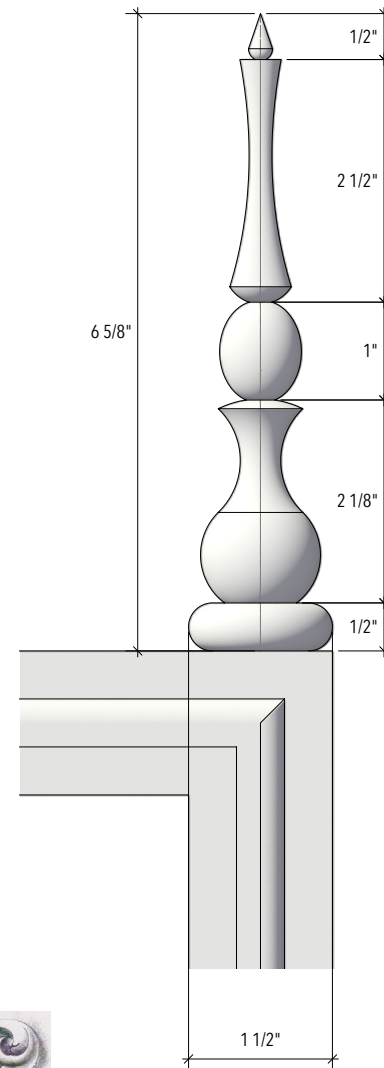

Snow White and The Seven Dorks
by Adam Day Howard

Creative Team:

- Directing: Kenn McLaughlin
- Costume Design: Leah Smith
- Lighting Design: Jared Gooding
- Prop: Jodi Bobrovsky
- Music directing: Steven Jones
- Choreographer: Harrison Guy
- Technical Directing: Joel Burkholder
- Scenic Design: Inseung Park
- Drafting: Inseung Park

Stages Repetory Theatre

Title:

Mirror

Scale:

2"=1'-0"

Date:

Sep 5, 2022



S.D. 13829
SCENIC DESIGNER

SIGNATURE *Inseung Park*

E-1 Projection screen: front

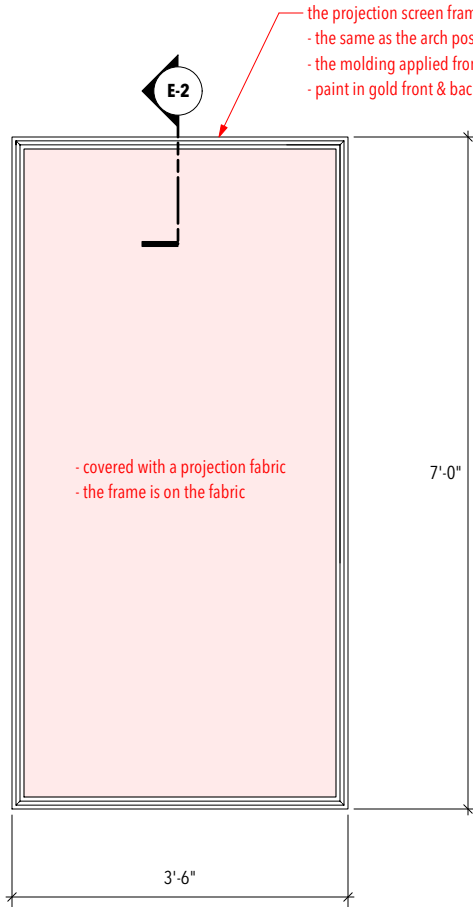

- the projection screen frame:
- the same as the arch posts - the same color scheme aging gold
- the molding applied front & back
- paint in gold front & back

E-2 Projection screen: section

scale: 1:1 life scale

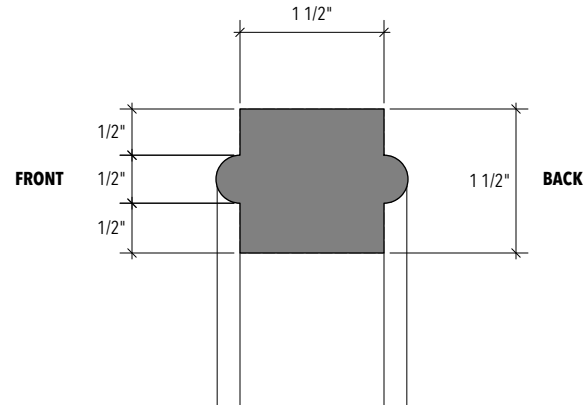

E-3 Projection screen: plan



Snow White and The Seven Dorks
by Adam Day Howard

Creative Team:

- Directing: Kenn McLaughlin
- Costume Design: Leah Smith
- Lighting Design: Jared Gooding
- Prop: Jodi Bobrovsky
- Music directing: Steven Jones
- Choreographer: Harrison Guy
- Technical Directing: Joel Burkholder
- Scenic Design: Inseung Park
- Drafting: Inseung Park

Stages Repetory Theatre

Title:

Projection screen

Scale:

1"=1'-0"

Date:

Sep 5, 2022



S.D. 13829
SCENIC DESIGNER

SIGNATURE *Inseung Park*