

3-J upper stairs: isometric view
 Scale: 1" = 1'-0"

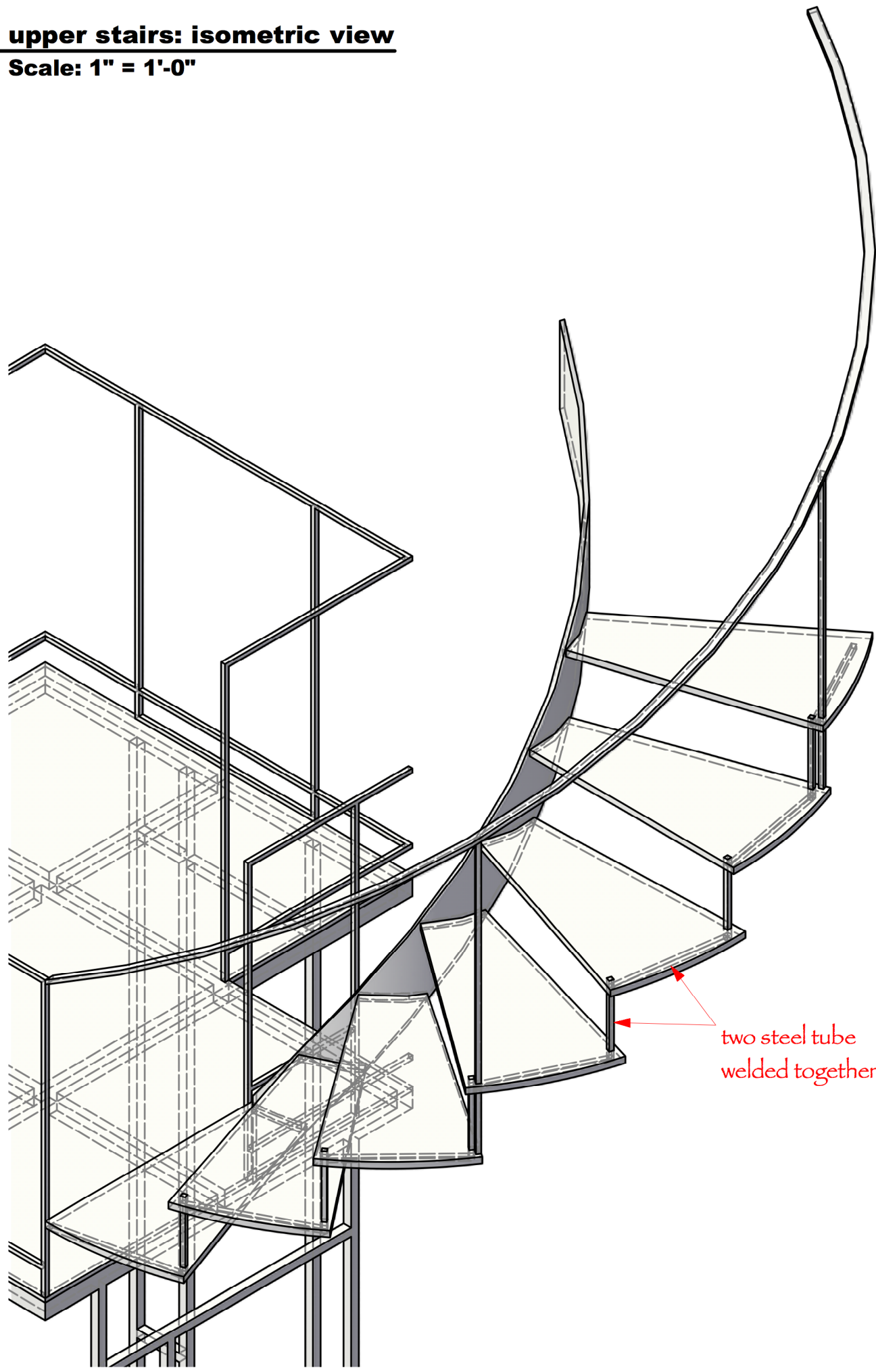

two steel tube welded together

3-K lower stairs: isometric view
 Scale: 1" = 1'-0"

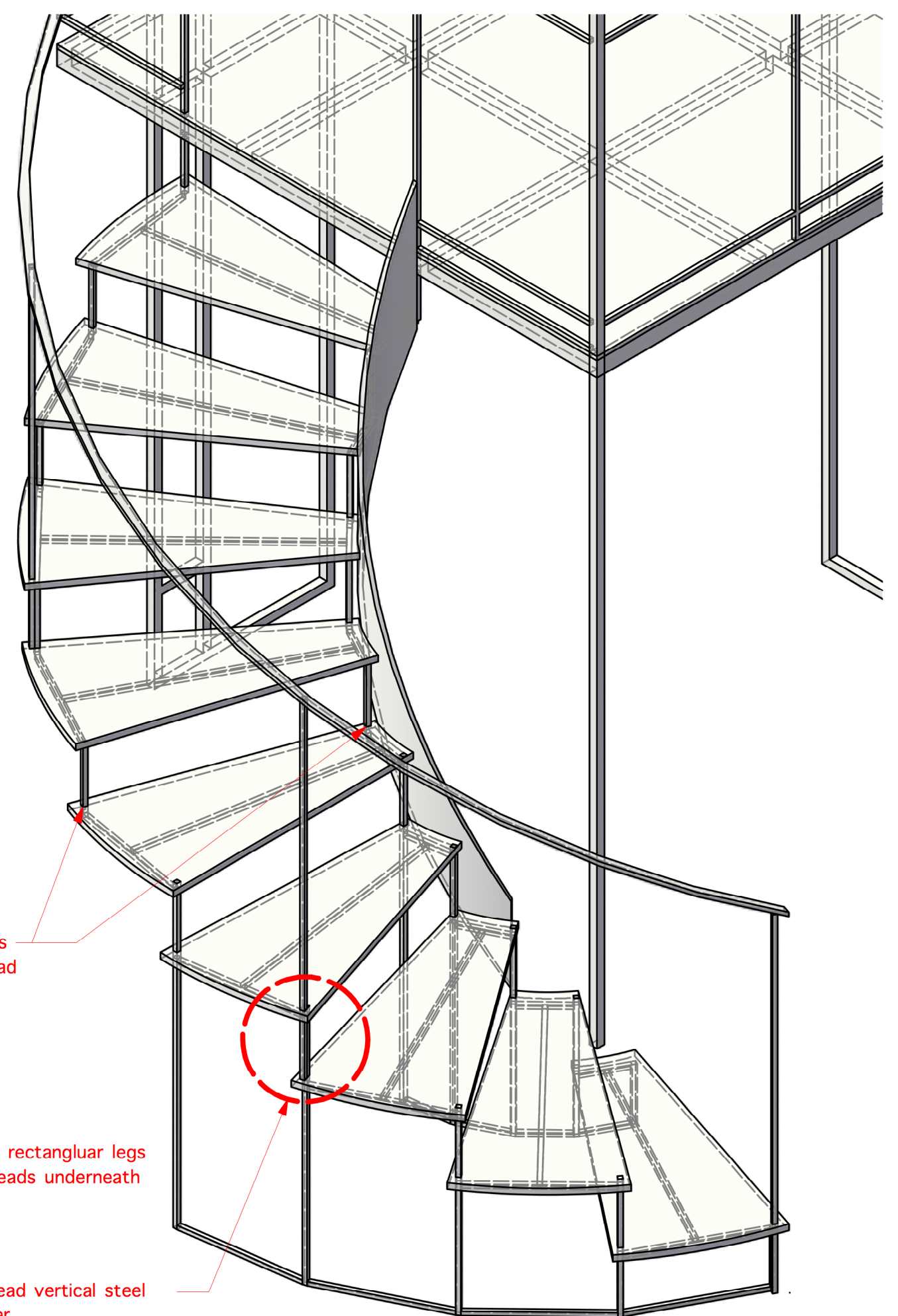

No vertical legs at the 5th tread

- only four rectangular legs for four treads underneath

handrail and tread vertical steel welded together

THEATRE 3

Director: Tiffany Greene
 Scenic Designer: Inseung Park
 Technical Director: Jon Leitch
 Artistic Director: Jeffrey Schmidt

LES LIAISONS DANGEREUSES

Drafter: Inseung Park Date: May 1, 2018

Upper & lower stairs: isometric view

Scale: 1"=1'-0"